

HTCP

Hi-Tech Engineering Products



Pipe Supports & Strut Systems

Systems That Make Sense





Introduction to the top notch services and expertise that we provide may not be needed for those who know the sincere jobs done by us. We take pride to boast that we are one of the best service providers among the leading technocrats in the U.A.E.

With an experience of more than a decade and a premises fully equipped with all kinds of engineering machinery and a qualified staff, we are prepared for any work-specification to meet our customer's satisfaction. We believe in your contentment and hold high our time and quality commitments.

The services provided by us include.

1. Manufacturing - U-Bolts, Anchor bolts, Tower bolts, Corner clips, Clamps, Spacers, Washers, Threaded bars, Specific hardware and so on.
2. Fabrication and Cladding - Cladding, Structural steel fabrication, Metal decorative, Cable ladders, Marble clamps and so on.
3. Electro-Galvanizing - Zinc plating of scaffolding, fasteners, flanges, angles, beams, etc.
4. Machining work - Turning, Shaping, Drilling, Threading and Milling.

Beside these we undertake all kinds of Metal works of stainless steel, carbon steel, brass, cast iron and many more.

In the past years we have successfully completed projects related to fabrication, replacement and repair of mechanical parts for Rubber and Plastic factories, Rope factories, Marble factories, Food processing companies, etc. The list of our successful achievements and satisfied clients is never ending. Our clientele includes oilfield companies and suppliers as well as construction companies and building material suppliers. We have also undertaken sub - contracts of all kinds of metal works and structural steel including decorative works for Hotels, Malls and Resorts.

We also trade in Hardware such as Welding electrodes, Nuts, Washers, Fix- Bolts, Shafting bars and so on.

We strive to provide the best service possible and are proud to have it. We believe that the true value of our work is customer satisfaction.

With kind Regards,

Y. K. Noorani.
Managing Director

1	Pipe Clamps.....	1
2	Riser Clamps.....	3
3	Clevis Hangers.....	3
4	Threaded Attachments.....	4
5	Concrete Attachments.....	5
6	Welded Beam Attachment.....	6
7	Flat Plate Fittings.....	7
8	90° Angle Fittings.....	10
9	Angular Fittings.....	16
10	Braces.....	17
11	Clevis Fittings.....	18
12	U-fittings.....	19
13	Z-fittings.....	23
14	Wing Fittings.....	26
15	Post Bases.....	29
16	Steel - Accessories.....	31

Fig. : 111

Standard Pipe Clamp

Function: Designed to be used in the suspension of non-insulated pipe lines

Material: Low carbon steel

Finish: Plain, Electro-Galvanized

Ordering: Specify pipe size and figure number

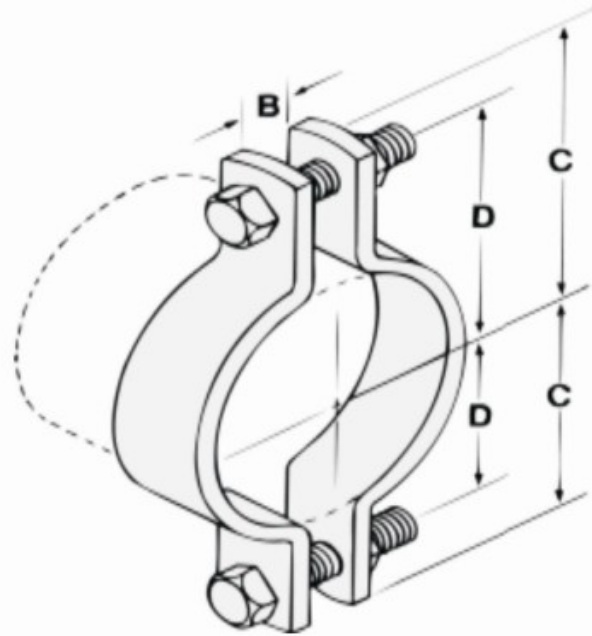

Pipe Size	B	C	D	Bolt Size	Max. Rec. Load/lbs.		Wt. Each (in lbs.)
					650 F	750 F	
1/2	3/8	1 9/16	1 1/16	3/8	500	445	.31
3/4	3/8	1 3/4	1 1/4	3/8	500	445	.35
1	3/8	1 7/8	1 3/8	3/8	500	445	.39
1 1/4	3/8	2 1/8	1 5/8	3/8	500	445	.40
1 1/2	3/8	2 1/4	1 3/4	3/8	800	715	.45
2	1/2	2 9/16	2 1/16	1/2	1040	930	.90
2 1/2	5/8	3 1/8	2 5/8	1/2	1040	930	1.10
3	5/8	3 9/16	2 13/16	1/2	1040	930	1.20
3 1/2	5/8	3 11/16	3 3/16	1/2	1040	930	1.25
4	3/4	4 1/8	3 3/8	5/8	1040	930	1.85
5	3/4	4 3/4	4 1/8	5/8	1040	930	2.05
6	7/8	5 3/4	4 7/8	3/4	1615	1440	5.06
8	1	7	6	3/4	1615	1440	6.08
10	1	8 9/16	7 9/16	7/8	2490	2220	12.81
12	1	9 7/8	8 7/8	7/8	2490	2220	13.08
14	1 1/8	11 9/16	9 15/16	7/8	2490	2220	16.70
16	1 1/8	12 5/8	10 7/8	7/8	2490	2220	23.19
18	1 1/4	13 3/8	11 5/8	1	3060	2730	33.12
20	1 3/8	14 9/16	12 9/16	1 1/8	3060	2730	38.66
24	1 5/8	17 1/4	15 1/2	1 1/4	3060	2730	52.27
30	2	20 7/8	18 5/8	1 1/2	4000	3520	105.13

*Available in stainless steel.
To order, specify 304 or 316 and add suffix SS to figure number.
Price on request.

Fig. : 112

Heavy Duty Pipe Clamp

Function: Designed to be used in the suspension of non-insulated pipe lines where heavier loads are to be suspended.

Material: Low carbon steel

Finish: Plain, Electro-Galvanized

Ordering: Specify pipe size and figure number

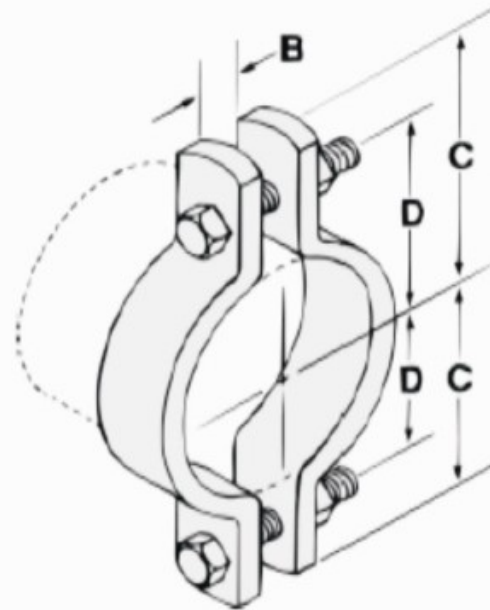

Pipe Size	B	C	D	Bolt Size	Max. Rec. Load/lbs.		Wt. Each (in lbs.)
					650 F	750 F	
3	1	4 1/8	3	3/4	3370	3005	4.96
3 1/2	1	4 3/8	3 1/4	3/4	3370	3005	5.36
4	1	4 15/16	3 11/16	7/8	3515	3135	5.74
5	1	5 9/16	4 5/16	7/8	3515	3135	7.13
6	1 1/8	6 11/16	5 3/16	1	4865	4340	13.48
8	1 1/8	7 3/4	6 1/4	1	4865	4340	15.78
10	1 1/4	9 1/2	7 7/8	1 1/4	6010	5360	24.20
12	1 5/8	11 9/8	9 1/2	1 1/2	8675	7740	41.54
14	1 5/8	12 1/4	10 1/8	1 1/2	9120	8135	53.25
16	1 5/8	13 9/16	11 3/16	1 1/2	9120	8135	56.35
18	1 5/8	14 9/16	12 3/16	1 1/2	9150	8160	70.12
20	1 5/8	15 1/16	13 3/16	1 1/2	9150	8160	74.68
24	1 3/4	17 3/4	15 3/8	1 1/2	9200	8205	126.29

*Available in stainless steel.
To order, specify 304 or 316 and add suffix SS to figure number.
Price on request.

Note: Larger sizes available upon request.

Fig. : 113
Heavy Duty Double Bolt Pipe Clamp

Function: Designed for the suspension of high temperature pipe lines. The increased material and bolt sizes allow these to be used in applications where heavier loads will be encountered

Material: Low carbon steel

Finish: Plain, Electro-Galvanized

Ordering: Specify pipe size and figure number

Available in stainless steel.

To order, specify 304 or 316 and suffix SS to figure number. Price on request.

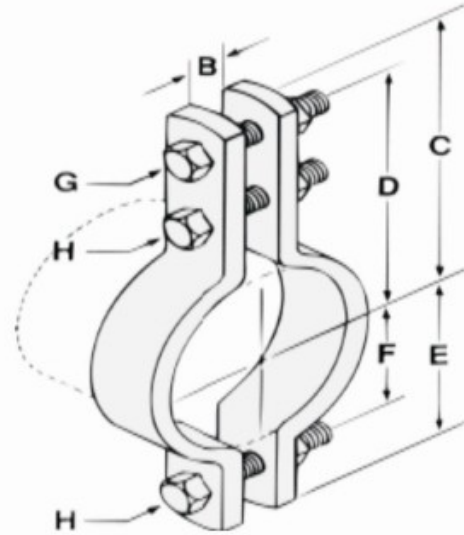

Pipe Size	Bolt Size					Max. Rec. load/lbs.		Wt. Each (in lbs.)		
	B	C	D	E	F	G	H		650° F	750° F
6	1 3/4	11 1/8	8 7/8	6 1/16	4 3/16	1	7/8	3500	3125	14.14
8	2	11 3/16	9 15/16	7 7/16	6 3/16	1 1/8	1	4800	4285	20.99
10	2 1/4	12 15/16	11 3/8	9 3/16	7 7/16	1 1/4	1 1/8	5500	4910	33.71
12	2 1/2	14	12 1/4	10 11/16	8 15/16	1 1/2	1 1/4	7000	6250	48.17
14	2 1/2	15 1/8	13 1/16	12	10	1 1/2	1 1/4	9500	8485	70.50
16	3	16 13/16	14 9/16	13 7/16	11 3/16	1 3/4	1 1/2	10000	8930	93.90
18	3 1/2	18 13/16	16 9/16	15 5/16	12 13/16	2	1 3/4	13800	12325	123.72
20	3 1/2	19 15/16	17 7/16	16 7/16	13 15/16	2	1 3/4	15300	13665	156.43
24	3 1/2	22 1/2	19 1/2	19	16	2	1 3/4	16300	14555	204.65

Note: Larger sizes available upon request.

Fig. : 114
OFFSET PIPE CLAMP

Function: Designed to be used in the clamping of pipe lines at a fixed distance away from the floor or wall

Material: Low carbon steel

Finish: Plain, Electro-Galvanized

Ordering: Specify pipe size and figure number

Available in stainless steel.

To order, specify 304 or 316 and add suffix SS to figure number. Price on request.

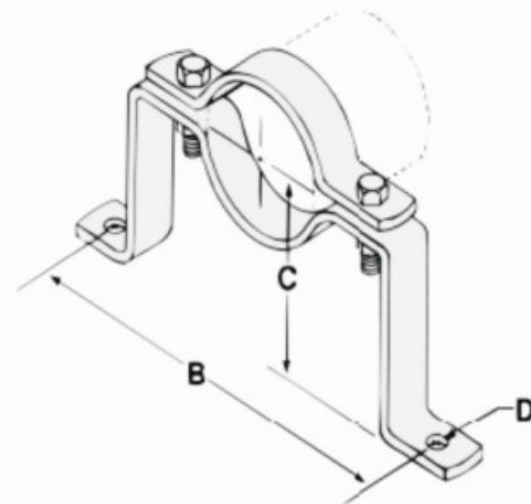

Pipe Size	B	C	D	Bolt Size	Max. Rec. load/lbs.	Wt. Each (in lbs.)
3/4	5 7/8	2 1/2	7/16	3/8	190	0.87
1 1/2	6	2 5/8	7/16	3/8	190	0.92
1 3/4	6 1/2	2 3/4	7/16	3/8	190	1.15
1 1/2	6 9/16	3	7/16	3/8	190	1.24
2	7 11/16	3 3/16	7/16	3/8	420	1.56
2 1/2	8 3/8	3 7/16	7/16	3/8	420	1.78
3	8 13/16	3 1/2	7/16	3/8	420	1.98
3 1/2	9 3/4	4	7/16	3/8	420	2.45
4	11	4 1/4	9/16	1/2	610	3.00
5	12 1/8	4 3/4	9/16	1/2	610	3.50
6	14 3/8	5 9/16	9/16	1/2	870	6.50
8	16 1/2	6 9/16	9/16	1/2	870	7.90
10	19 1/8	7 3/4	11/16	5/8	870	12.70
12	25 1/2	8 7/8	11/16	5/8	870	21.20

Fig. : 115

Function: Designed For Supporting And Stabilizing Vertical Pipe Runs
 Material: Low Carbon Steel
 Finish: Plain, Electro-Galvanized
 Ordering: Specify Pipe Size And Figure Number

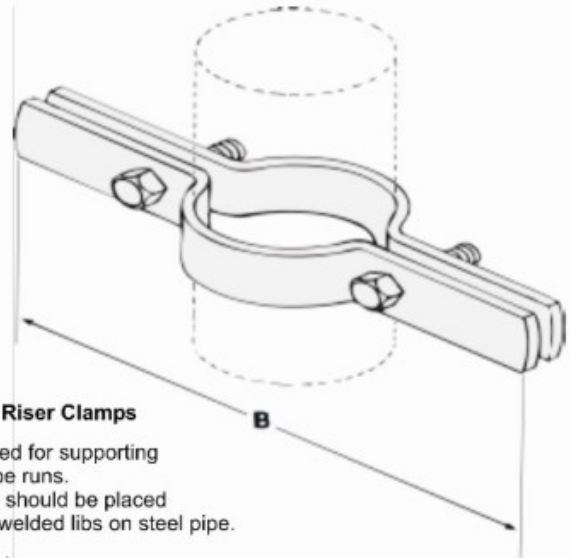

Installation practice for Riser Clamps

The riser clamp is designed for supporting and stabilizing vertical pipe runs. When possible the clamp should be placed under a coupling, hub or welded lips on steel pipe.

Available in stainless steel. To order, specify 304 or 316 and add suffix SS to figure number. Price on request.

Pipe Size	Bolt Size	Max. Rec. Load/lbs.	Wt. Each (in lbs.)
1/2	9	220	1.05
3/4	9 3/8	220	1.10
1	9 5/8	220	1.10
1 1/4	10	250	1.60
1 1/2	10 3/8	250	1.60
2	10 3/4	300	1.70
2 1/2	11 1/4	400	1.90
3	11 3/4	500	1.90
3 1/2	13	600	2.30
4	13 1/2	750	2.40
5	14 1/2	1500	3.60
6	16	1600	4.00
8	18	2500	7.60
10	21 1/2	2500	11.10
12	24	2700	16.50
14	25	2700	17.70
16	26 1/4	2900	30.40
18	28 3/8	2900	33.30
20	30	2900	36.30
24	34 3/4	2900	46.68
30	40 3/4	2900	60.16

CLEVIS HANGERS

Fig. : 116

Standard Clevis Hanger

Function: Designed for the suspension of non-insulated stationary pipe lines
 Material: Low carbon steel
 Finish: Plain, Electro-Galvanized
 Ordering: Specify pipe size and figure number

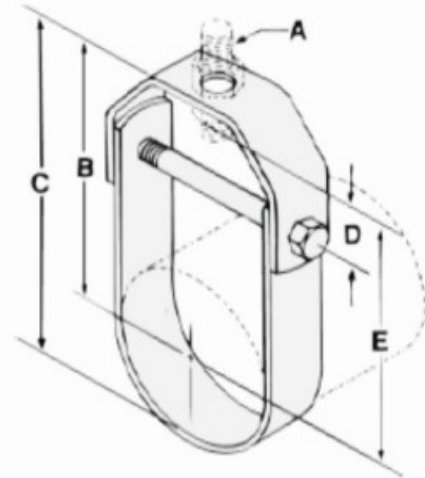

"D" Adjustment
 (Top of cross bolt to bottom of hanger rod nut)

Note: When an over-sized clevis is used, a pipe spacer should be placed over the clevis bolt to prevent the lower U-strap from moving inward.

*Available in stainless steel. To order, specify 304 or 316 and add suffix SS to figure number. Price on request.

Pipe Size	Rod Size	A	B	C	D	E	Cross Bolt	Max. Rec. Load/lbs.	Wt. Each (in lbs.)
1/2	3/8	2 7/16	2 7/8	1 1/8	2	1/4	610	.31	
3/4	3/8	2 5/8	3 1/8	1 1/4	2 3/16	1/4	610	.33	
1	3/8	3 1/16	3 3/4	1 5/8	2 5/8	1/4	610	.37	
1 1/4	3/8	3 3/8	4 3/16	1 5/8	2 15/16	1/4	610	.41	
1 1/2	3/8	3 1/2	4 7/16	1 1/2	3 1/16	1/4	610	.44	
2	3/8	3 3/4	5	1 5/8	3 9/16	1/4	610	.52	
2 1/2	1/2	3 7/8	5 3/8	1 1/8	3 1/4	3/8	1130	1.02	
3	1/2	4 1/4	6	1 1/8	3 3/8	3/8	1130	1.10	
3 1/2	1/2	4 1/2	6 1/2	1 1/4	3 7/8	3/8	1130	1.22	
4	5/8	5 1/2	7 11/16	1 3/4	4 11/16	3/8	1430	1.56	
5	5/8	6 1/8	9 1/8	1 7/8	5 5/16	1/2	1430	2.05	
6	3/4	6 7/8	10 1/8	1 5/8	6	1/2	1940	2.66	
8	7/8	8 3/4	12 7/8	2 1/8	7 7/8	5/8	2000	4.17	
10	7/8	9 1/4	14 5/8	1 3/4	8 1/8	3/4	3600	8.11	
12	7/8	11 5/8	18	2 1/2	10 1/2	3/4	3800	10.05	
14	1	12 3/4	19 3/4	2 5/8	11 1/4	7/8	4200	12.97	
16	1	14 1/8	22 1/8	2 5/8	13 5/8	1	4600	20.85	
18	1 1/8	16 1/2	25 1/2	3 1/2	15	1 1/8	4800	24.75	
20	1 1/4	18	28	4 1/8	16 1/8	1 1/4	4800	42.45	
24	1 1/4	20 1/4	32 1/4	4 3/4	18 3/8	1 1/4	4800	48.65	
30	1 1/4	24 1/2	38 7/8	5 1/2	21 1/2	1 1/4	6000	69.83	
36	1 1/2	32	50	8 3/4	30	1 1/2	9500	175.00	

SQUARE PLATE WASHER

Available in stainless steel.
To order, specify 304 or 316 and add suffix SS.
Price on request.

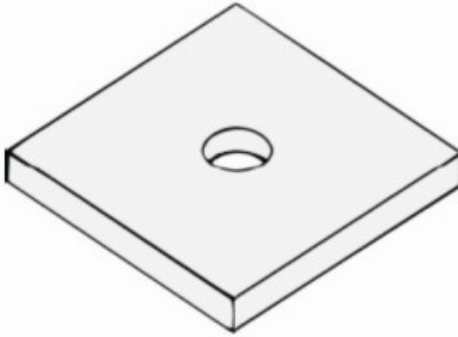

U BOLT

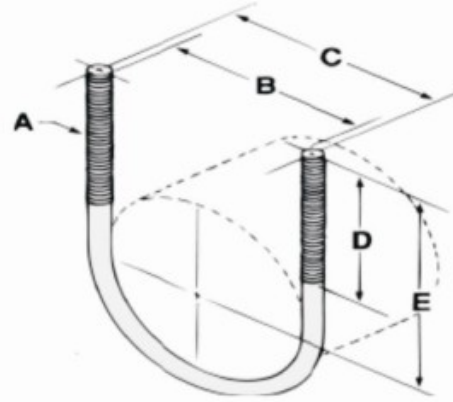

Available in stainless steel. To order, specify 304 or 316 and add suffix SS.
Price on request.

ENGINEERING STUD

RIGHT-HAND THREADS
RIGHT AND LEFT-HAND
THREADS

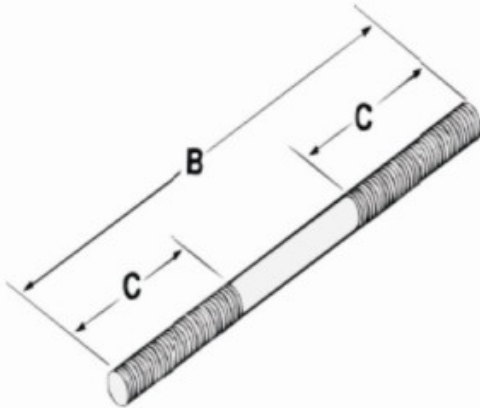

EYE BOLT

RIGHT-HAND THREADS
LEFT-HAND THREADS

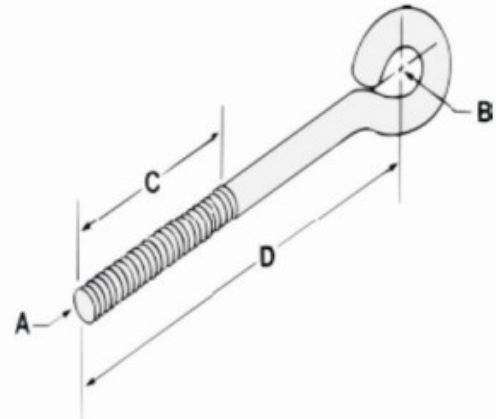

J-BOLT

MATERIAL : Low carbon steel
FINISH : Plain, Electro-Galvanized

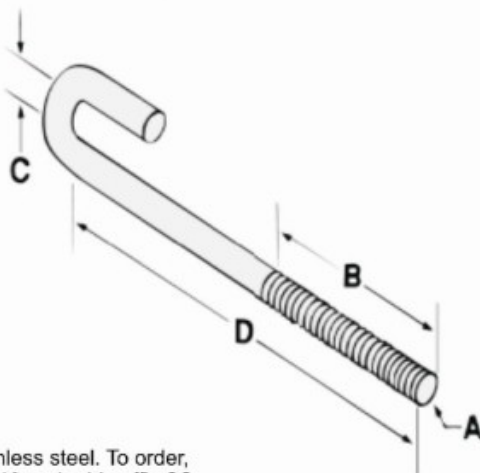

Available in stainless steel. To order, specify 304 or 316 and add suffix SS.
Price on request.

ANCHOR BOLT

MATERIAL : Low carbon steel
FINISH : Plain, Electro-Galvanized

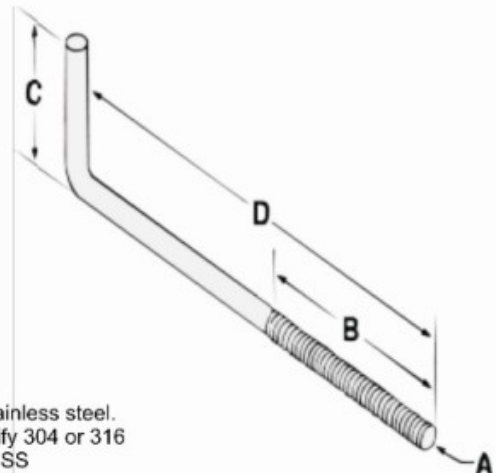

Available in stainless steel.
To order, specify 304 or 316 and add suffix SS.
Price on request.

Fig. : 221

Concrete Rod Attachment Plate

Function: Designed for attaching hanger rod to concrete ceiling.

Material: Low carbon steel

Finish: Plain, Electro-Galvanized

Ordering: Specify rod size and figure number.

Available in stainless steel.
To order, specify 304 or 316 and add
suffix SS to figure number.
Price on request.

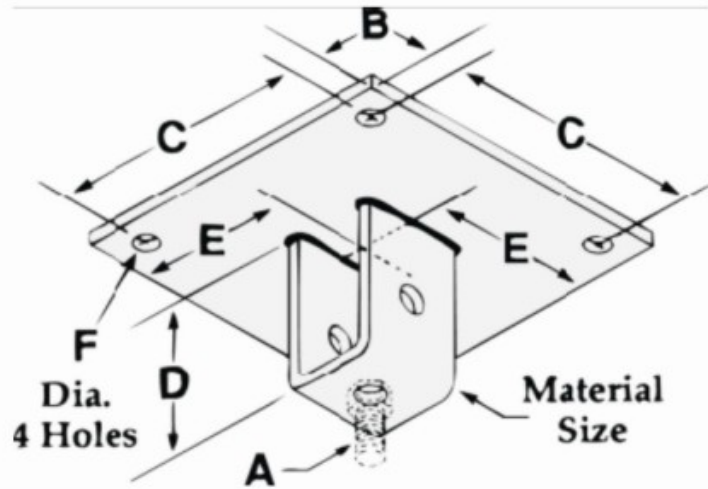

Rod Size A	B	C	D	E	F	Plate Size	Max. Rec. load/lbs.	Wt. Each (in lbs.)
3/8	1	8	2 7/8	5	5/16	10 x 10 x 3/8	610	11.60
1/2	1	8	2 7/8	5	5/16	10 x 10 x 3/8	1130	11.60
5/8	1	8	2 7/8	5	5/16	10 x 10 x 3/8	1810	15.10
3/4	1	8	3 1/4	5	11/16	10 x 10 x 1/2	2710	16.10
7/8	1	8	4 1/4	5	13/16	10 x 10 x 1/2	3770	16.70
1	2	8	4 1/2	6	13/16	12 x 12 x 1/2	4960	34.90
1 1/8	2	8	4 3/4	6	13/16	12 x 12 x 1/2	6230	35.25
1 1/4	2	8	5	6	13/16	12 x 12 x 3/4	8000	38.70
1 1/2	2	8	6 1/2	6	1 1/16	12 x 12 x 1	11630	56.40
1 3/4	2	10	7 3/4	7	1 3/8	14 x 14 x 1 1/4	15700	88.10
2	2	10	8 1/4	7	1 3/8	14 x 14 x 1 1/4	20700	92.20

Fig. : 222

Concrete Clevis Plate

Function: Designed for use as a structural attachment to a concrete ceiling.

Material: Low carbon steel

Finish: Plain, Electro-Galvanized

Ordering: Specify rod size and figure number.

Available in stainless steel.
To order, specify 304 or 316 and add
suffix SS to figure number.
Price on request.

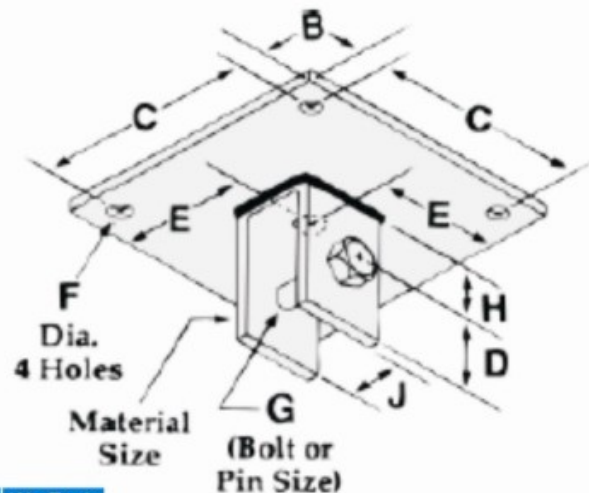

Rod Size	B	C	D	E	F	G	H	Plate Size	Max. Rec. load/lbs.	Wt. Each (in lbs.)
3/8	1	8	7/8	5	5/16	1/2	2	10 x 10 x 3/8	610	11.80
1/2	1	8	7/8	5	5/16	5/8	2	10 x 10 x 3/8	1130	11.90
5/8	1	8	7/8	5	5/16	3/4	2	10 x 10 x 3/8	1810	15.70
3/4	1	8	1 1/4	5	11/16	7/8	2	10 x 10 x 1/2	2710	16.90
7/8	1	8	1 1/4	5	11/16	1	3	10 x 10 x 1/2	3770	18.10
1	2	8	1 1/2	6	13/16	1 1/8	3	12 x 12 x 1/2	4960	36.90
1 1/8	2	8	1 3/4	6	13/16	1 1/4	3	12 x 12 x 1/2	6230	37.75
1 1/4	2	8	2	6	15/16	1 3/8	3	12 x 12 x 3/4	8000	40.90
1 1/2	2	8	2 1/2	6	1 1/16	1 3/8	4	12 x 12 x 1	11630	59.80
1 3/4	2	10	2 3/4	7	1 3/8	1 3/8	5	14 x 14 x 1 1/4	15700	93.60
2	2	10	3 1/4	7	1 3/8	2 1/4	5	14 x 14 x 1 1/4	20700	100.00

Note : The 1" size and larger are furnished with pin and cotter.

Fig. : 223

Welded Beam Attachment

Function : Designed for attaching hanger rod to the bottom flange of a beam. If installed in the inverted position, the hanger rod can be vertically adjusted otherwise bolt and nut are required.

Material : Low carbon steel

Finish : Plain, Electro-Galvanized

Ordering : Specify rod size and figure number.

Available in stainless steel.
To order, specify 304 or 316 and add
suffix SS to figure number.
Price on request.

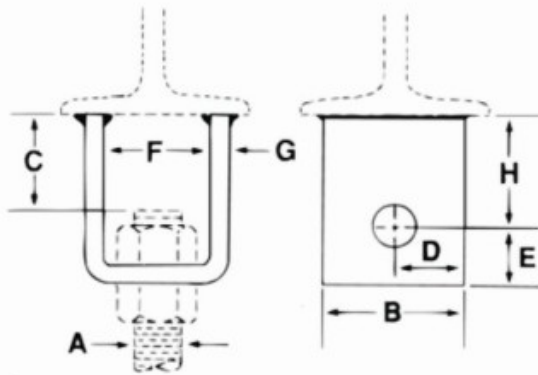
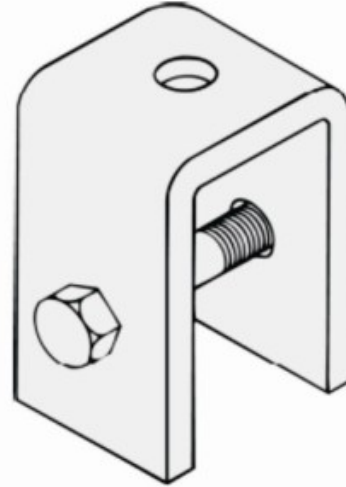

Welded design
furnished on 1½"
and larger.

Rod Size	A	B	C	D	E	F	G	H	Bolt or Pin Size	Max. Rec. load/lbs.		Wt. Each (in lbs.)	
										650° F	750° F	w/o B&N	with B&N
3/8	2	1 7/8	1	7/8	1 1/4	3 ga.	2	1/2 X 2 1/2	610	510	0.87	1.13	
1/2	2	1 3/4	1	7/8	1 1/4	3 ga.	2	5/8 X 2 1/2	1130	940	0.85	1.28	
5/8	2	1 3/4	1	7/8	1 1/4	3 ga.	2	3/4 X 2 1/2	1810	1510	0.84	1.50	
3/4	2 1/2	2	1 1/4	1 1/4	2 1/4	3/8	2	7/8 X 4	2710	2260	2.00	3.04	
7/8	2 1/2	3	1 1/4	1 1/4	2 3/8	3/8	3	1 X 4 1/2	3770	3150	2.50	4.02	
1	3	3	1 1/2	1 1/2	2 3/4	1/2	3	1 1/8 X 5 1/2	4960	4150	4.14	6.30	
1 1/8	3	3	1 1/2	1 3/4	3	1/2	3	1 1/4 X 5	6230	5200	4.37	7.15	
1 1/4	4	3 1/2	2	2	3 1/2	5/8	3	1 3/8 X 6 1/2	8000	6660	8.50	12.62	
1 1/2	5	4	2 1/2	2 1/2	3	3/4	4	1 5/8 X 6	11630	9700	16.41	23.23	
1 3/4	5	5	2 1/2	2 3/4	3 3/4	3/4	5	1 7/8 X 7	15700	14000	18.70	24.20	
2	6	5 1/4	3	3 1/4	3 3/4	3/4	5	2 1/4 X 7	20700	18460	22.80	30.60	

Note : The 1" size and larger are furnished with pin and cotter.

HT-1

- Standard finishes : ZN

SQUARE WASHER

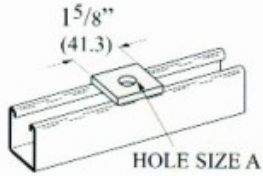

Part No.	A	(A)	Bolt Size		Wt./C	
			Lbs.	Kg	Lbs.	Kg
HT-1A	3/8"	(9.5)	5/16"	(7.9)	18	(8.1)
HT-1B	7/16"	(11.1)	3/8"	(9.5)	18	(8.1)
HT-1C	9/16"	(14.2)	1/2"	(12.7)	17	(7.7)
HT-1D	1 1/16"	(17.4)	9/8"	(15.9)	16	(7.2)
HT-1E	1 3/16"	(20.6)	3/4"	(19.0)	15	(6.8)

HT-2

- Standard finishes : ZN

NO TWIST SQUARE WASHER

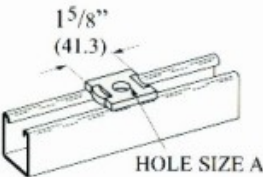

Part No.	A	(A)	Bolt Size		Wt./C	
			Lbs.	Kg	Lbs.	Kg
HT-2A	3/8"	(9.5)	5/16"	(7.9)	18	(8.1)
HT-2B	7/16"	(11.1)	3/8"	(9.5)	18	(8.1)
HT-2C	9/16"	(14.2)	1/2"	(12.7)	17	(7.7)
HT-2D	1 1/16"	(17.4)	9/8"	(15.9)	16	(7.2)
HT-2E	1 3/16"	(20.6)	3/4"	(19.0)	15	(6.8)

HT-3

TWO HOLE SPLICE PLATE

- Standard finishes: ZN
- Wt./C 37 Lbs. (16.8 Kg)

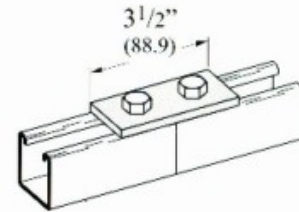

HT-4

TWO HOLE SPLICE PLATE

- Standard finishes : ZN
- Wt./C 34 Lbs. (15.4Kg)

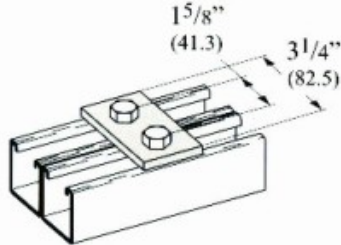

HT-5

TWO HOLE SPLICE PLATE

- Standard finishes : ZN
- Wt./C 50 Lbs. (22.7Kg)

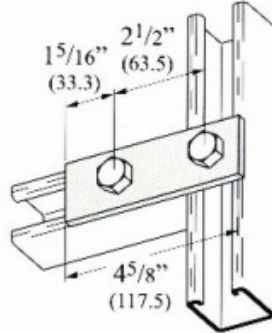

HT-6

THREE HOLE SPLICE PLATE

- Standard finishes : ZN
- Wt./C 55Lbs. (24.9Kg)

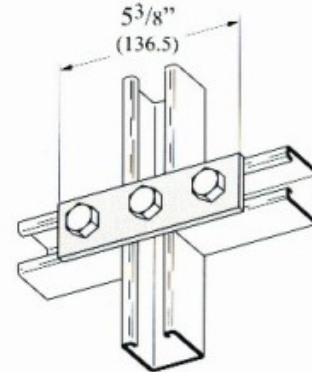

HT-7

THREE HOLE SPLICE PLATE

- Standard finishes: ZN
- Wt./C 50Lbs. (22.7Kg)

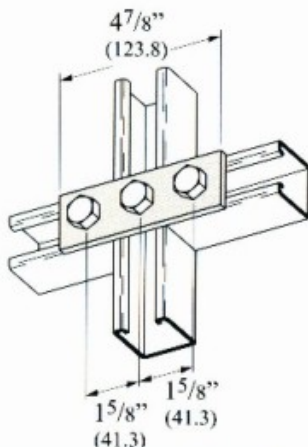

HT-8

FOUR HOLE SPLICE PLATE

- Standard finishes: ZN
- Wt./C 76Lbs. (34.5Kg)

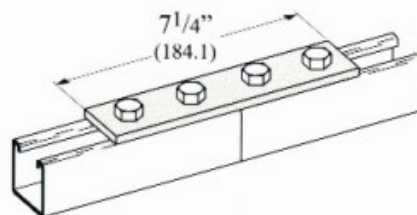

HT-9

FIVE HOLE SPLICE PLATE

- Standard finishes: ZN
- Wt./C 96Lbs. (43.5Kg)

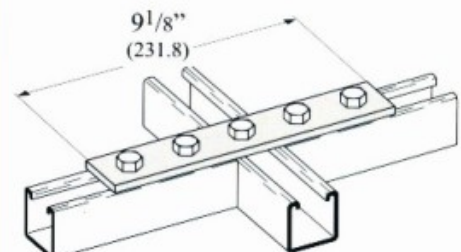

**HT-10
TWO HOLE SWIVEL PLATE**

- Standard finishes : ZN
- Wt./C 48Lbs. (21.8Kg)

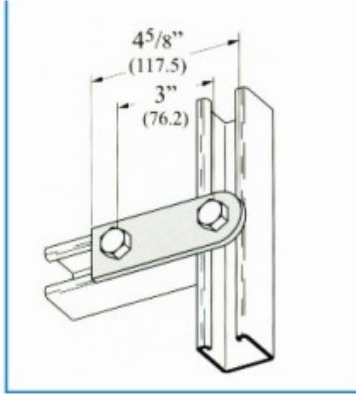

**HT-11
THREE HOLE SWIVEL PLATE**

- Standard finishes : ZN
- Wt./C 69Lbs. (31.3Kg)

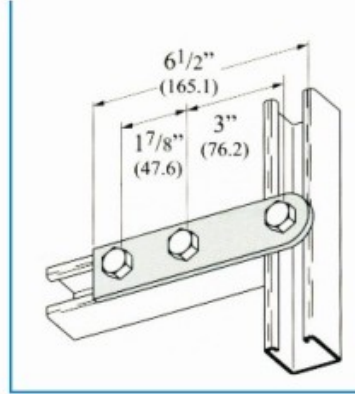

**HT-12
FOUR HOLE SPLICE PLATE**

- Standard finishes : ZN
- Wt./C 73Lbs. (33.1Kg)

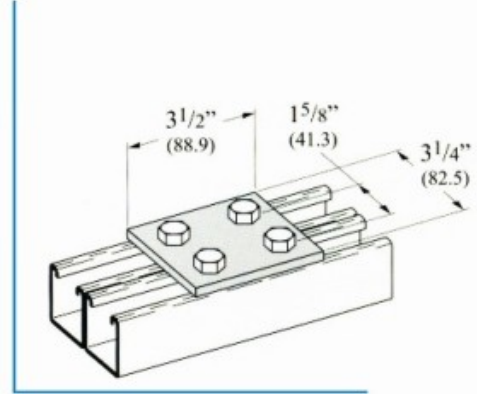

**HT-13
THREE HOLE CORNER PLATE**

- Standard finishes : ZN
- Wt./C 56Lbs. (25.4Kg)

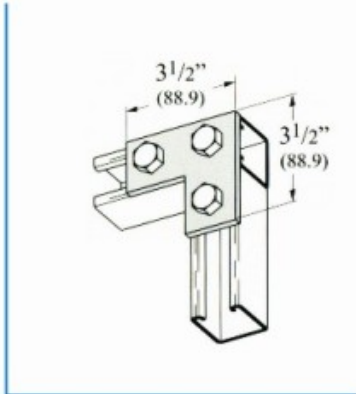

**HT-14
FOUR HOLE CORNER PLATE**

- Standard finishes : ZN
- Wt./C 75Lbs. (34.0Kg)

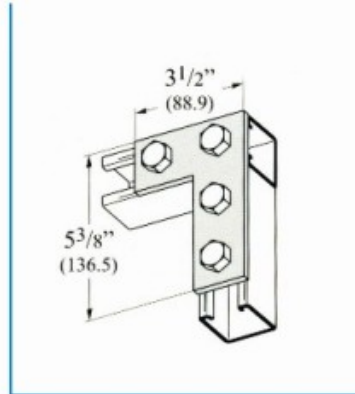

**HT-15
FOUR HOLE TEE PLATE**

- Standard finishes : ZN
- Wt./C 75Lbs. (34.0Kg)

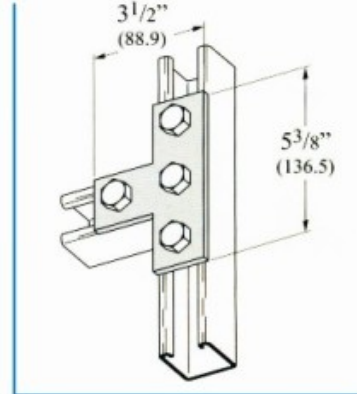

**HT-16
FIVE HOLE CROSS PLATE**

- Standard finishes : ZN
- Wt./C 100Lbs. (45.3Kg)

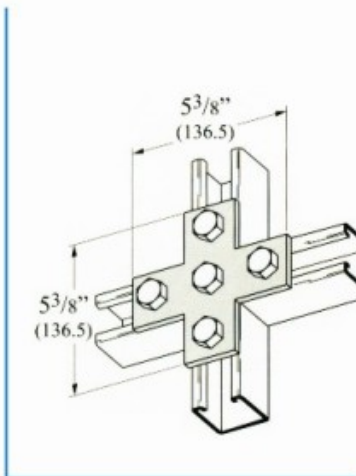

**HT-17
THREE HOLE CORNER GUSSET PLATE**

- Standard finishes : ZN
- Wt./C 70Lbs. (31.7Kg)

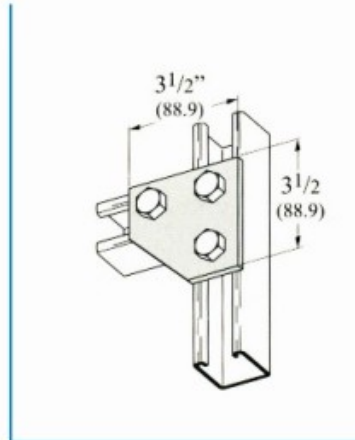

**HT-18
FOUR HOLE CORNER GUSSET PLATE**

- Standard finishes : ZN
- Wt./C 102 Lbs. (46.2Kg)

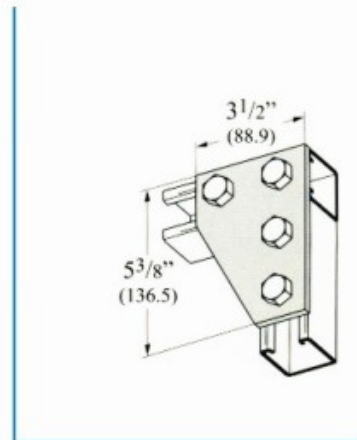

HT-19 FOUR HOLE CORNER GUSSET PLATE

- Standard finishes : ZN
- Wt./C 273 Lbs. (123.8Kg)

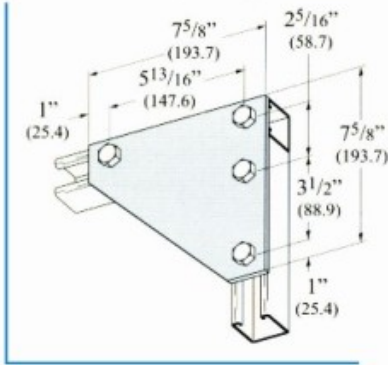

HT-20 FIVE HOLE CORNER GUSSET PLATE

- Standard finishes : ZN
- Wt./C 145 Lbs. (65.8Kg)

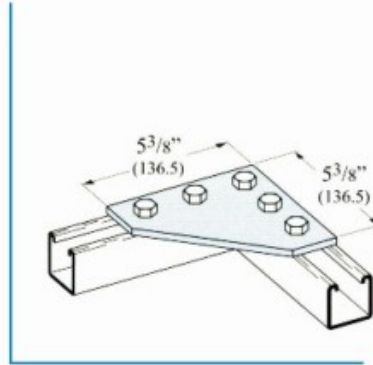

HT-21 THREE HOLE TEE GUSSET PLATE

- Standard finishes : ZN
- Wt./C 70 Lbs. (31.7Kg)

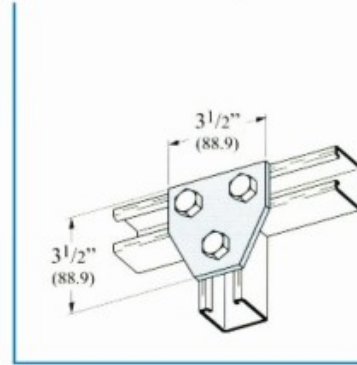

HT-22 FOUR HOLE TEE GUSSET PLATE

- Standard finishes : ZN
- Wt./C 100 Lbs. (45.3Kg)

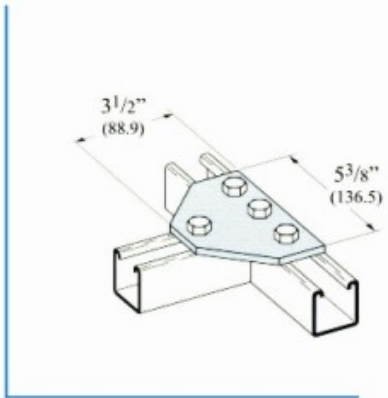

HT-23 FOUR HOLE TEE GUSSET PLATE

- Standard finishes : ZN
- Wt./C 100 Lbs. (45.3 Kg)

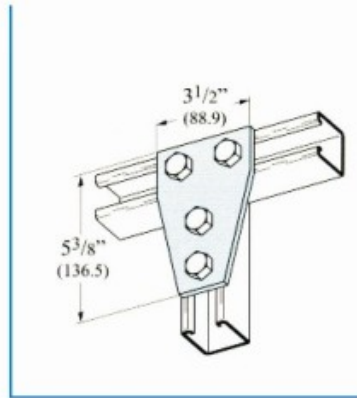

HT-24 FIVE HOLE TEE GUSSET PLATE

- Standard finishes : ZN
- Wt./C 143 Lbs. (64.8 Kg)

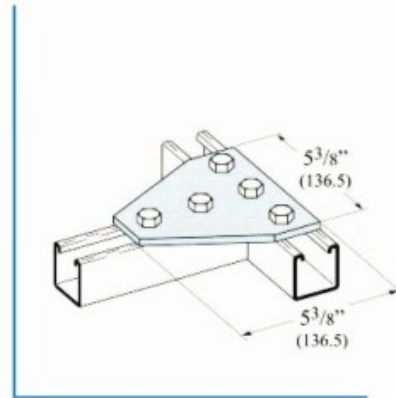

HT-25 SIX HOLE TEE GUSSET PLATE

- Standard finishes : ZN
- Wt./C 149 Lbs. (67.6 Kg)

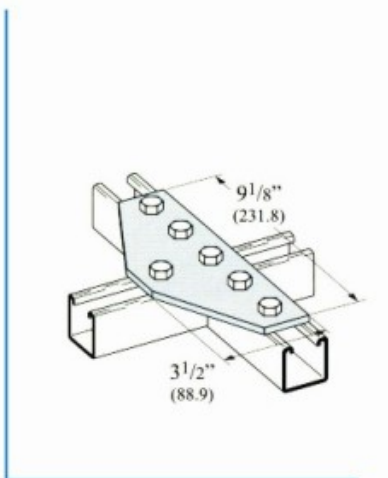

HT-26 SIX HOLE CROSS GUSSET PLATE

- Standard finishes : ZN
- Wt./C 166 Lbs. (75.3 Kg)

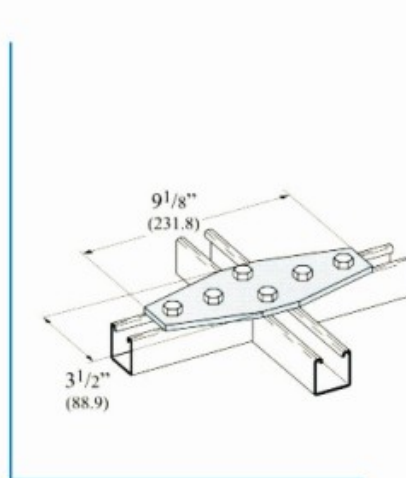

HT-27 SEVEN HOLE CROSS GUSSET PLATE

- Standard finishes : ZN
- Wt./C 232 Lbs. (105.2 Kg)

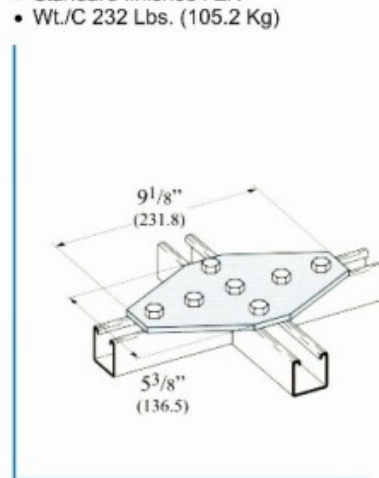

HT-28
ONE HOLE CORNER ANGLE

- Standard finishes : ZN
- Wt./C 75Lbs. (34.0Kg)

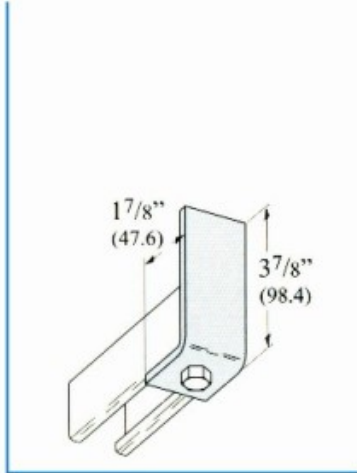

HT-29
ONE HOLE CORNER ANGLE

- Standard finishes : ZN
- Wt./C 85 Lbs. (38.5 Kg)

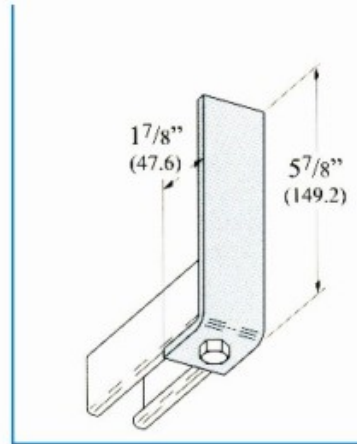

HT-30
ONE HOLE CORNER ANGLE

- Standard finishes : ZN
- Wt./C 107 Lbs. (48.5 Kg)

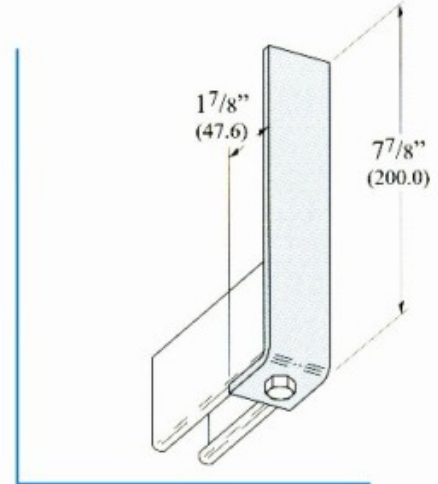

HT-31
ONE HOLE CORNER ANGLE

- Standard finishes : ZN
- Wt./C 129 Lbs. (58.5 Kg)

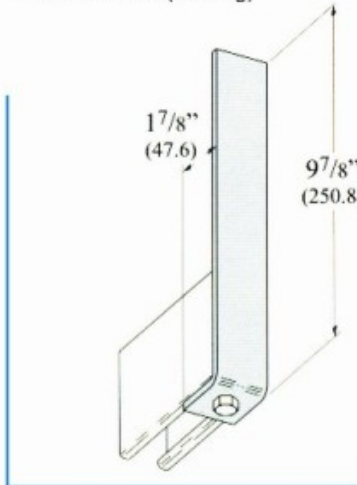

HT-32
TWO HOLE CORNER ANGLE

- Standard finishes : ZN
- Wt./C 37 Lbs. (16.8 Kg)

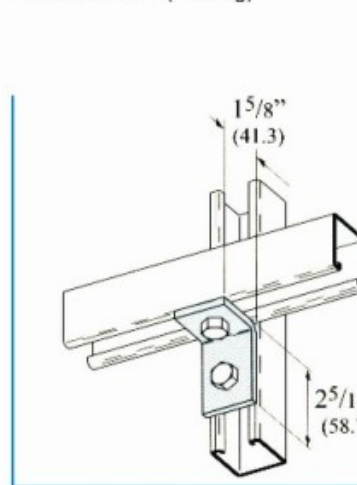

HT-33
TWO HOLE CORNER ANGLE

- Standard finishes : ZN
- Wt./C 37 Lbs. (16.8 Kg)

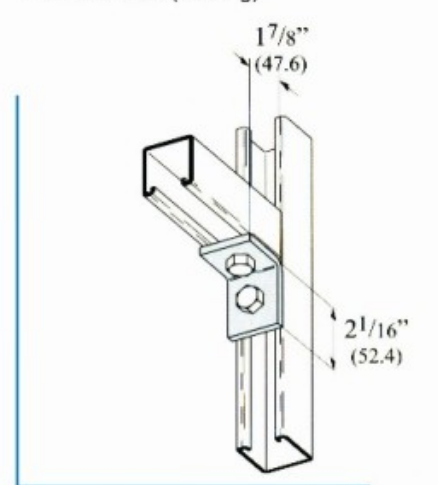

HT-34
TWO HOLE CORNER ANGLE

- Standard finishes : ZN
- Wt./C 53 Lbs. (24.0 Kg)

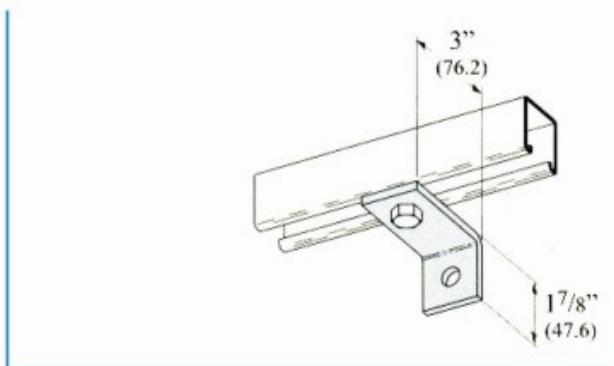

HT-35
TWO HOLE CORNER ANGLE

- Standard finishes : ZN
- Wt./C 60 Lbs. (27.2 Kg)

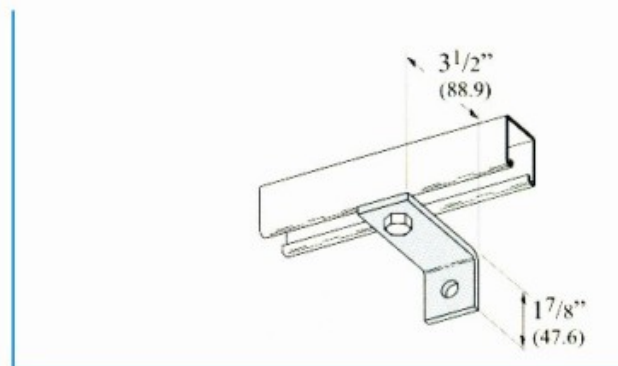

HT-36
TWO HOLE CORNER ANGLE

- Standard finishes : ZN
- Wt./C 56 Lbs. (25.4 Kg)

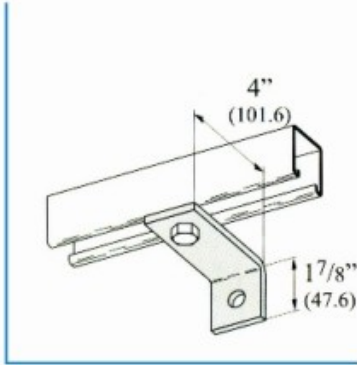

HT-37
THREE HOLE CORNER ANGLE

- Standard finishes : ZN
- Wt./C 56 Lbs. (25.4 Kg)

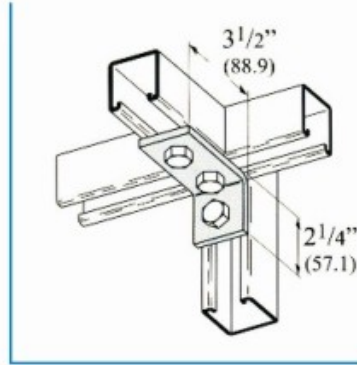

HT-38
THREE HOLE CORNER ANGLE

- Standard finishes : ZN
- Wt./C 56 Lbs. (25.4 Kg)

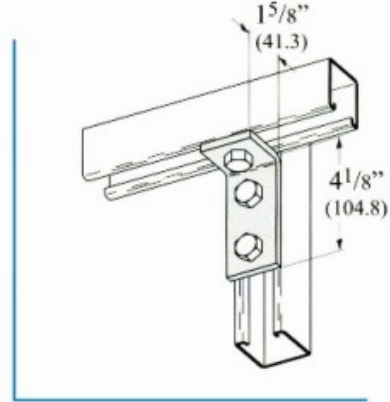

HT-39
THREE HOLE CORNER ANGLE

- Standard finishes : ZN
- Wt./C 56 Lbs. (25.4 Kg)

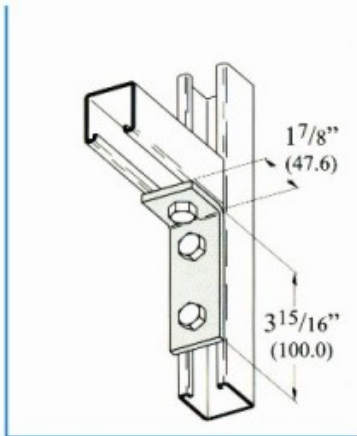

HT-40
THREE HOLE CORNER ANGLE

- Standard finishes : ZN
- Wt./C 78 Lbs. (35.4 Kg)

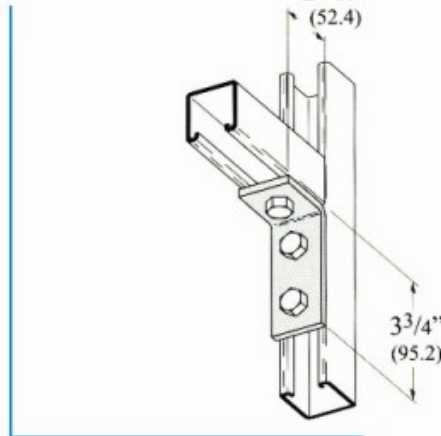

HT-41
THREE HOLE CORNER ANGLE

- Standard finishes : ZN
- Wt./C 78 Lbs. (35.4 Kg)

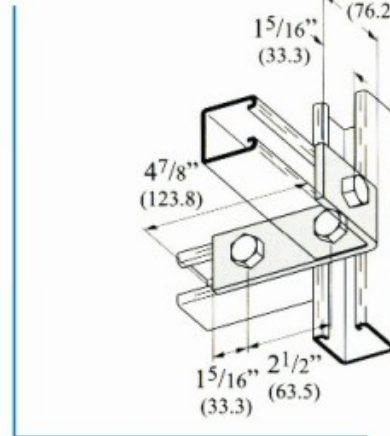

HT-42
FOUR HOLE CORNER ANGLE

- Standard finishes : ZN
- Wt./C 78 Lbs. (35.4 Kg)

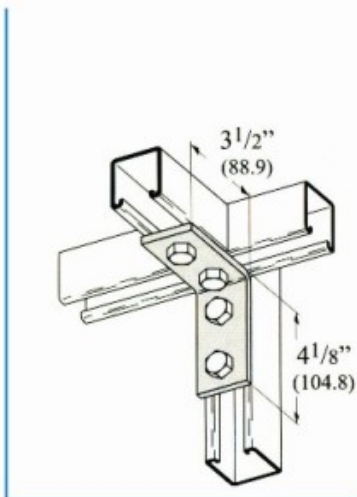

HT-43
FOUR HOLE CORNER ANGLE

- Standard finishes : ZN
- Wt./C 76 Lbs. (34.5 Kg)

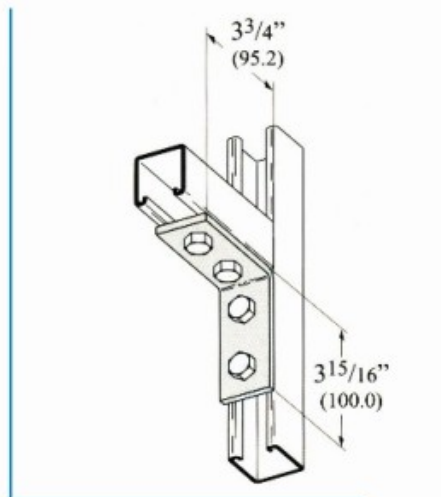

HT-44
FOUR HOLE CORNER ANGLE

- Standard finishes : ZN
- Wt./C 73 Lbs. (34.5 Kg)

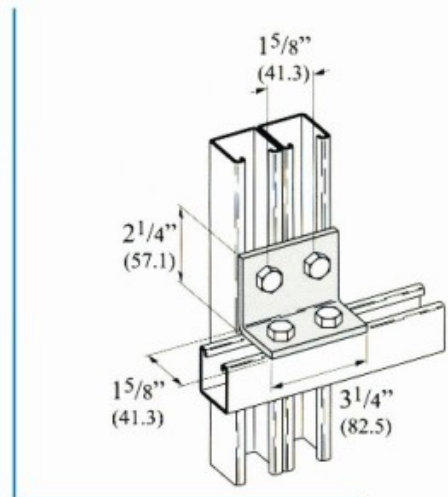

HT-45
THREE HOLE (RIGHT HAND)
OFFSET BENT ANGLE

- 1 5/8" (41.3) from center to center of the holes that are shown with bolt heads
- Standard finishes : ZN
- Wt./C 37 Lbs. (16.8 Kg)

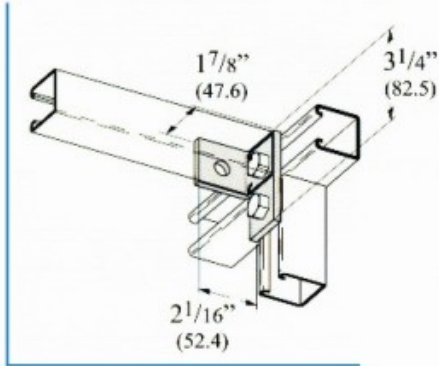

HT-46
THREE HOLE (LEFT HAND)
OFFSET BENT ANGLE

- 1 5/8" (41.3) from center to center of the holes that are shown with bolt heads
- Standard finishes : ZN
- Wt./C 37 Lbs. (16.8 Kg)

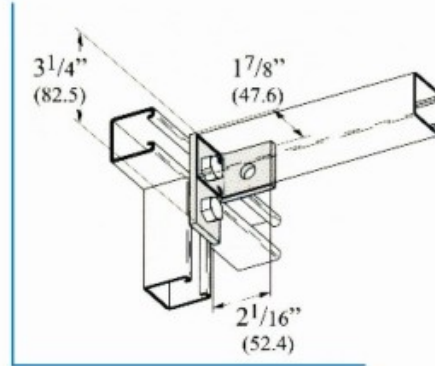

HT-47
THREE HOLE (RIGHT HAND)
OFFSET BENT ANGLE

- 1 5/8" (41.3) from center to center of the holes that are shown with bolt heads
- Standard finishes : ZN
- Wt./C 65 Lbs. (29.5 Kg)

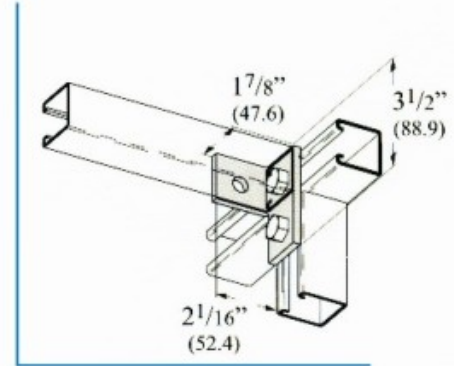

HT-48
THREE HOLE (LEFT HAND)
OFFSET BENT ANGLE

- Standard finishes : ZN
- Wt./C 65 Lbs. (29.5 Kg)

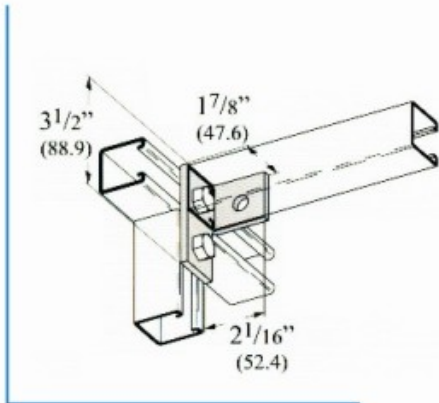

HT-49
THREE HOLE OFFSET BENT TEE

- Standard finishes : ZN
- Wt./C 71 Lbs. (32.2 Kg)

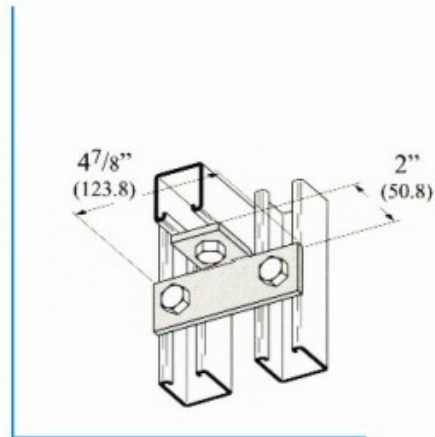

HT-50
FOUR HOLE OFFSET BENT TEE

- Standard finishes : ZN
- Wt./C 77 Lbs. (34.9 Kg)

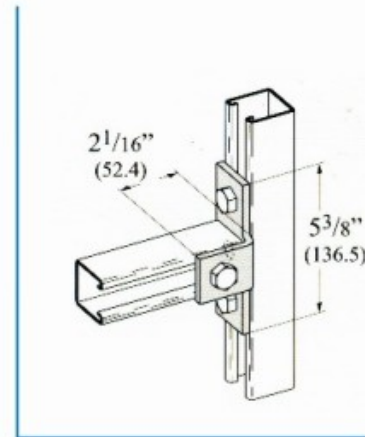

HT-51
FOUR HOLE (RIGHT HAND)
OFFSET BENT TEE

- Standard finishes : ZN
- Wt./C 76 Lbs. (34.5 Kg)

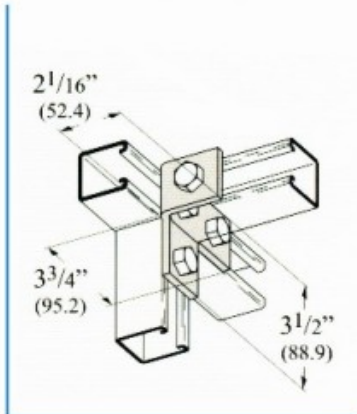

HT-52
FOUR HOLE (LEFT HAND)
OFFSET BENT TEE

- Standard finishes : ZN
- Wt./C 76 Lbs. (34.5 Kg)

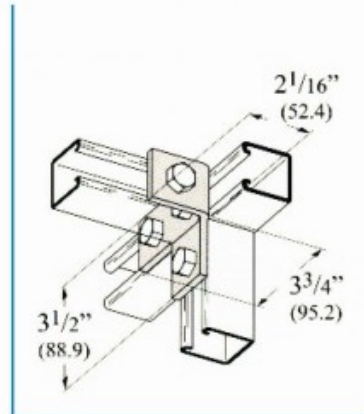

HT-53
FIVE HOLE OFFSET BENT TEE

- Standard finishes : ZN
- Wt./C 96 Lbs. (43.5 Kg)

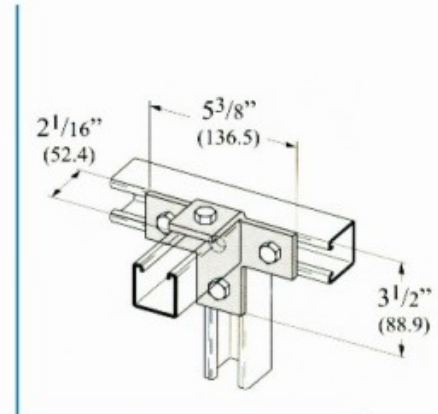

**HT-54
UNIVERSAL SHELF BRACKET**

- Standard finishes : ZN
- Wt./C 132 Lbs. (59.9 Kg)

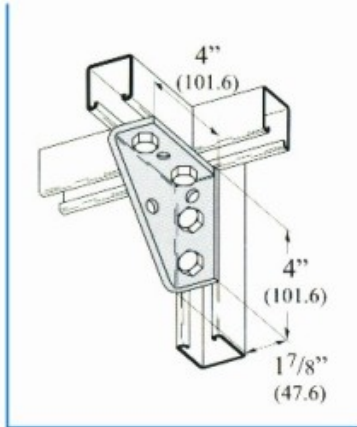

**HT-55
UNIVERSAL SHELF BRACKET-
WELDED**

- Standard finishes : ZN
- Wt./C 134 Lbs. (60.8 Kg)

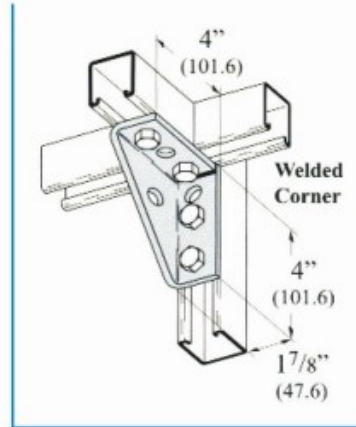

**HT-56
UNIVERSAL SHELF BRACKET-
WELDED**

- Standard finishes : ZN
- Wt./C 197 Lbs. (89.4 Kg)

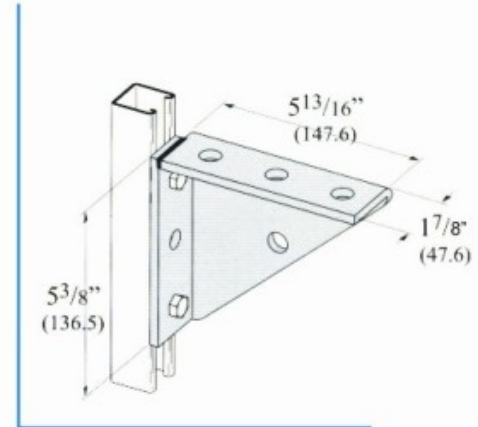

**HT-57
FOUR HOLE (RIGHT HAND)
CORNER GUSSET**

- Standard finishes : ZN
- Wt./C 100 Lbs. (45.3 Kg)

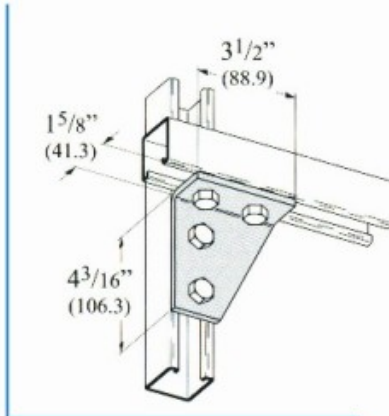

**HT-58
FOUR HOLE (LEFT HAND)
CORNER GUSSET**

- Standard finishes : ZN
- Wt./C 100 Lbs. (45.3 Kg)

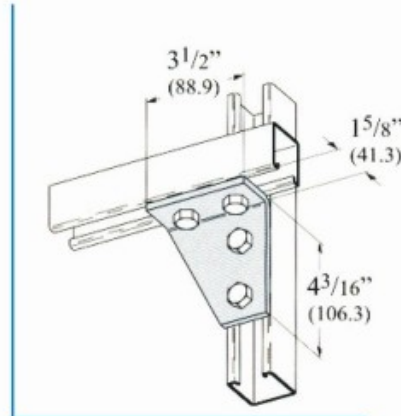

**HT-59
FOUR HOLE (RIGHT HAND)
CORNER GUSSET**

- Standard finishes : ZN
- Wt./C 100 Lbs. (45.3 Kg)

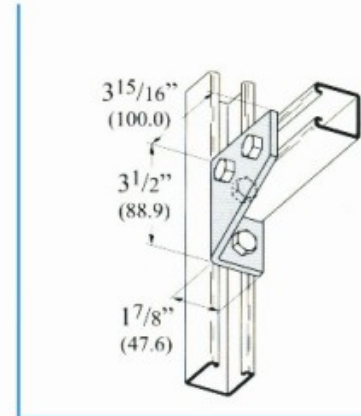

**HT-60
FOUR HOLE (LEFT HAND)
CORNER GUSSET**

- Standard finishes : ZN
- Wt./C 100 Lbs. (45.3 Kg)

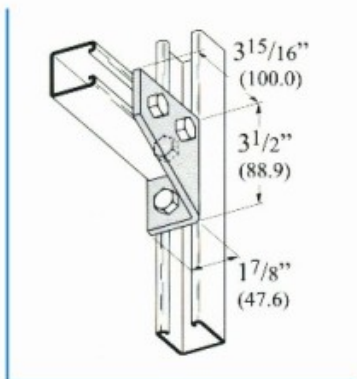

**HT-61
THREE HOLE GUSSETED
SHELF ANGLE**

- Standard finishes : ZN
- Wt./C 67 Lbs. (30.4 Kg)

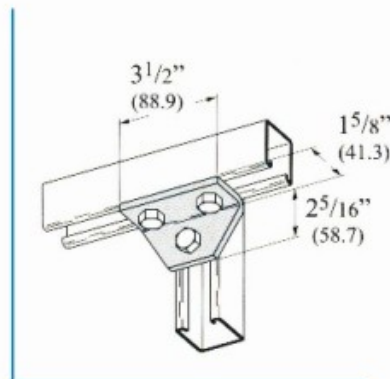

**HT-62
FOUR HOLE GUSSETED
SHELF ANGLE**

- Standard finishes : ZN
- Wt./C 102 Lbs. (46.2 Kg)

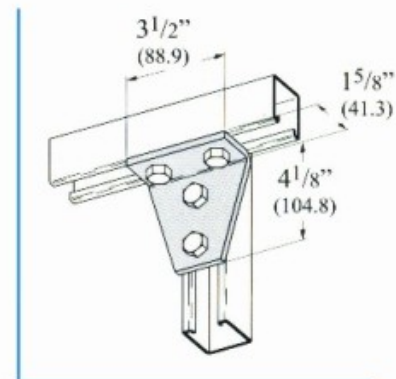

**HT-63
FIVE HOLE GUSSETED
SHELF ANGLE**

- Standard finishes : ZN
- Wt./C 148 Lbs. (67.1 Kg)

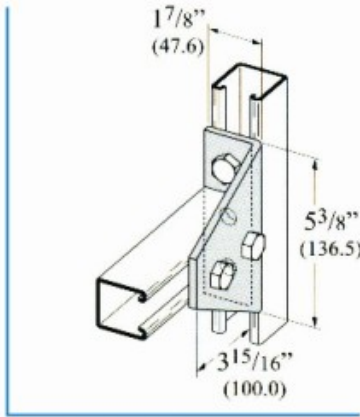

**HT-64
FIVE HOLE GUSSETED
SHELF ANGLE**

- Standard finishes : ZN
- Wt./C 141 Lbs. (63.9 Kg)

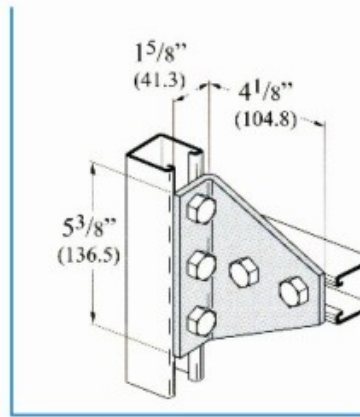

**HT-65
FOUR HOLE GUSSETED THREE
WAY SHELF ANGLE**

- Standard finishes : ZN
- Wt./C 101 Lbs. (45.8 Kg)

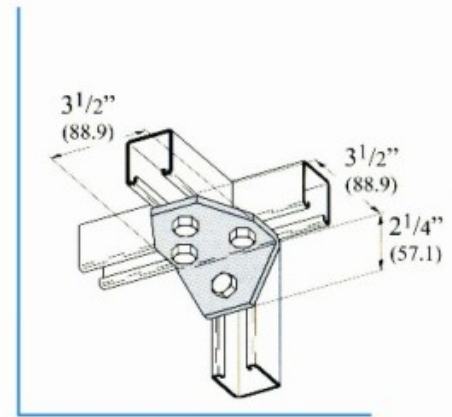

**HT-66
FIVE HOLE GUSSETED THREE
WAY SHELF ANGLE**

- Standard finishes : ZN
- Wt./C 135 Lbs. (61.2 Kg)

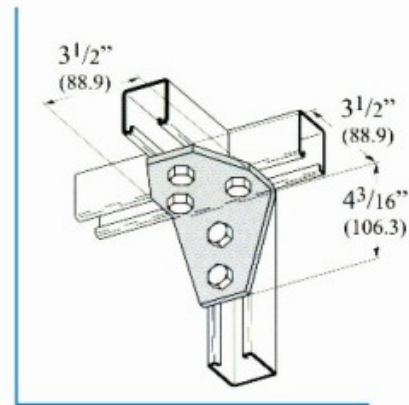

**HT-67
SIX HOLE (RIGHT HAND)
GUSSETED CORNER
CONNECTION**

- Standard finishes : ZN
- Wt./C 135 Lbs. (61.2 Kg)

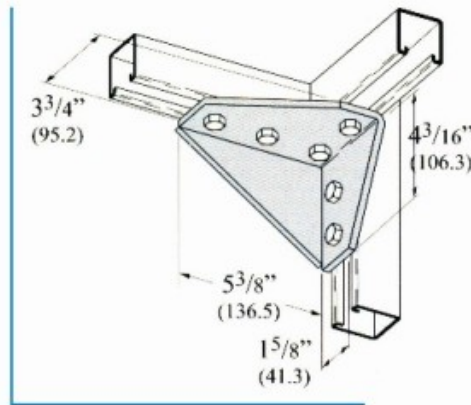

**HT-68
SIX HOLE (LEFT HAND)
GUSSETED CORNER
CONNECTION**

- Standard finishes : ZN
- Wt./C 135 Lbs. (61.2 Kg)

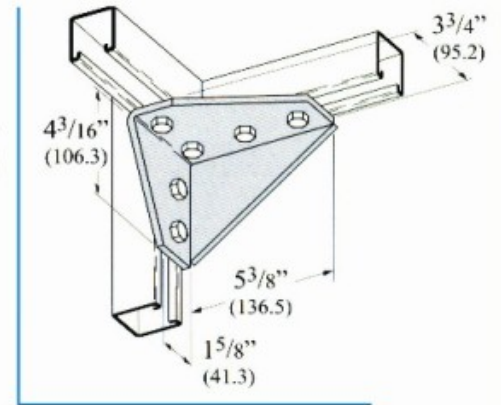

**HT-69
SEVEN HOLE CORNER
CONNECTION**

- Standard finishes : ZN
- Wt./C 256 Lbs. (116.1 Kg)

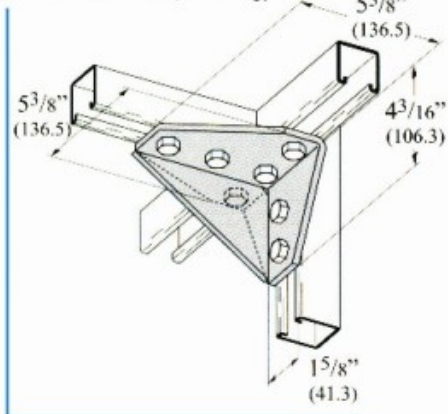

**HT-70
TWO HOLE ADJUSTABLE
ANGLE**

- Standard finishes : ZN
- Wt./C 33 Lbs. (14.9 Kg)

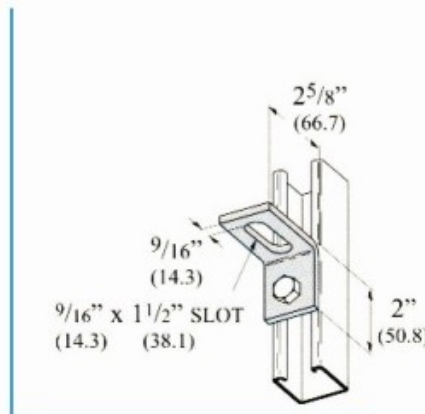

**HT-71
TWO HOLE ADJUSTABLE ANGLE**

- Standard finishes : ZN
- Wt./C 37 Lbs. (16.8 Kg)

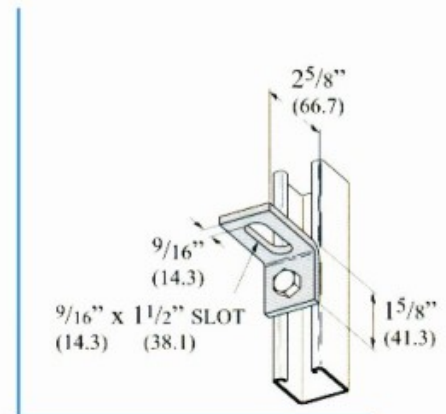

HT-72 TWO HOLE ADJUSTABLE CORNER ANGLE

- Standard finishes : ZN
- Wt./C 85 Lbs. (38.5 Kg)

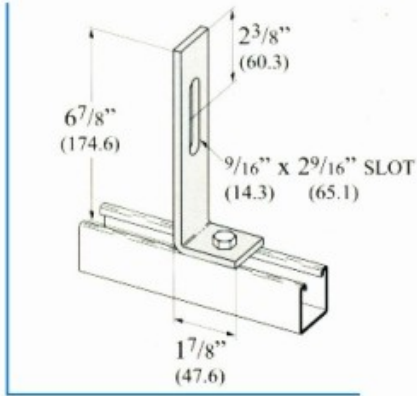

HT-73 TWO HOLE ADJUSTABLE CORNER ANGLE

- Standard finishes : ZN
- Wt./C 58 Lbs. (26.3 Kg)

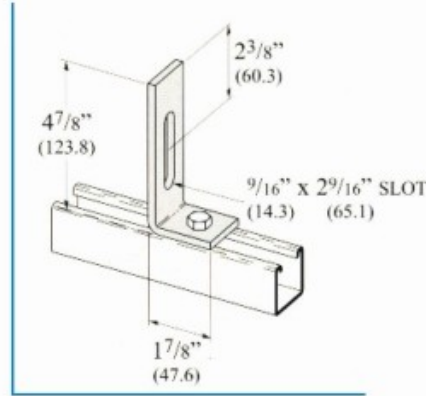

HT-74 THREE HOLE ADJUSTABLE CORNER ANGLE

- Standard finishes : ZN
- Wt./C 61 Lbs. (27.6 Kg)

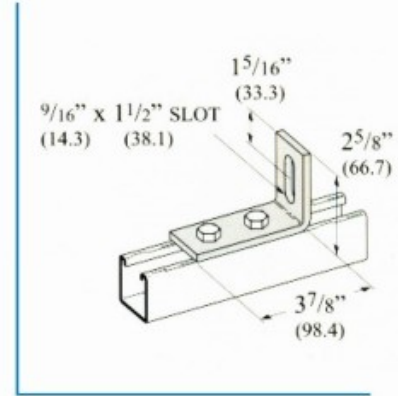

HT-75 THREE HOLE ADJUSTABLE CORNER ANGLE

- Standard finishes : ZN
- Wt./C 68 Lbs. (30.8 Kg)

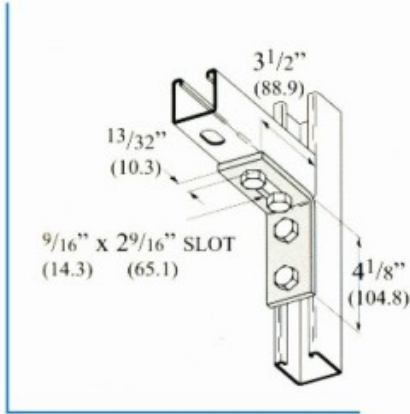

HT-76 TWO HOLE ADJUSTABLE CORNER ANGLE

- Standard finishes : ZN
- Wt./C 87 Lbs. (39.4 Kg)

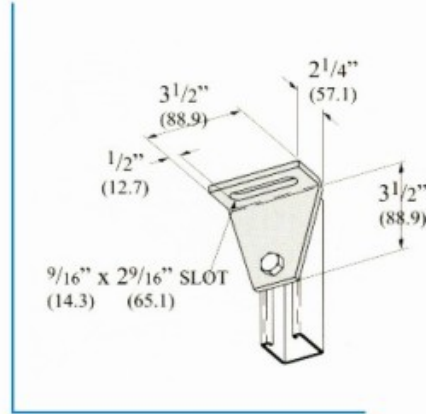

HT-77 FOUR HOLE ADJUSTABLE CORNER ANGLE

- Standard finishes : ZN
- Wt./C 180 Lbs. (81.6 Kg)

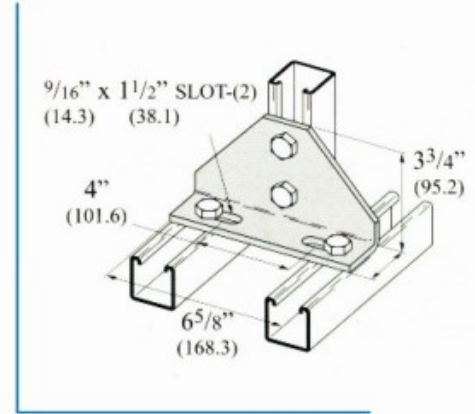

HT-78 FOUR HOLE ADJUSTABLE CORNER ANGLE

- Standard finishes : ZN
- Wt./C 78 Lbs. (35.4 Kg)

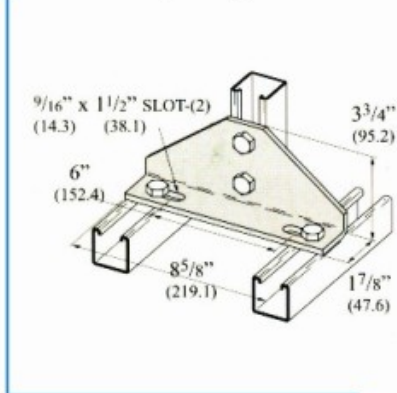

HT-79 TWO HOLE TAPPED CORNER ANGLE

- Standard finishes : ZN
- Wt./C 76 Lbs. (34.5 Kg)

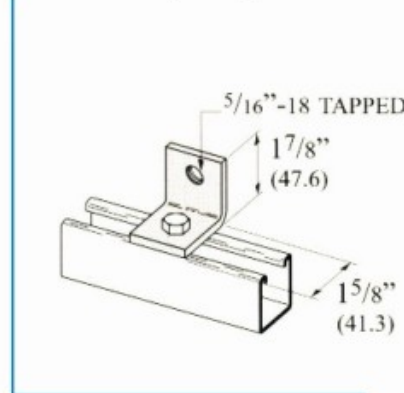

HT-80 TWO HOLE CORNER ANGLE

- Standard finishes : ZN
- Wt./C 73 Lbs. (34.5 Kg)

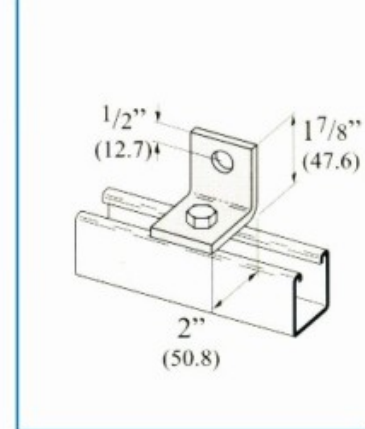

HT-81 TWO HOLE OPEN ANGLE

- Standard finishes : ZN

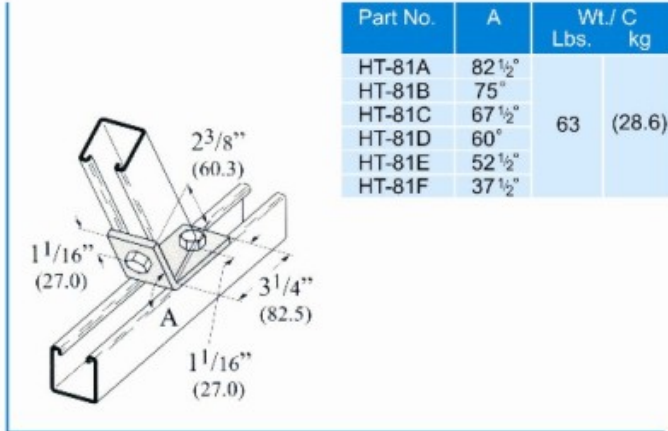

HT-82 FOUR HOLE OPEN ANGLE

- Standard finishes : ZN

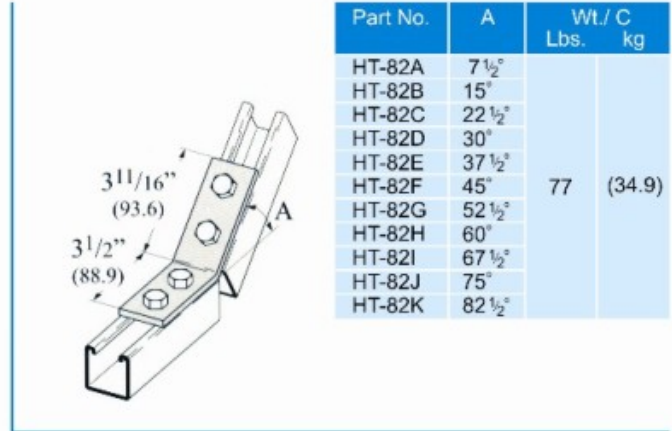

HT-83 TWO HOLE OPEN ANGLE

- Standard finishes : ZN

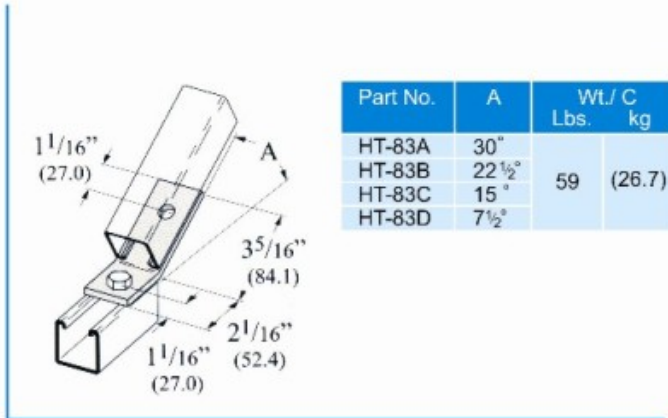

HT-84 TWO HOLE OPEN ANGLE

- Standard finishes : ZN
- Wt./C 55 Lbs. (26.3 Kg)

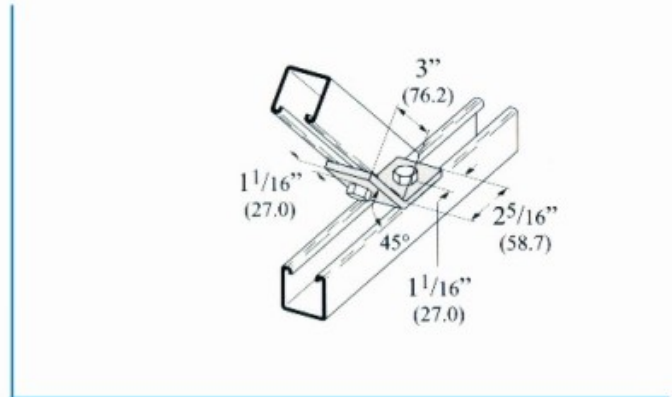

HT-85 THREE HOLE 95° OPEN ANGLE FITTING

- Standard finishes : ZN
- Wt./C 100 Lbs. (45.3 Kg)

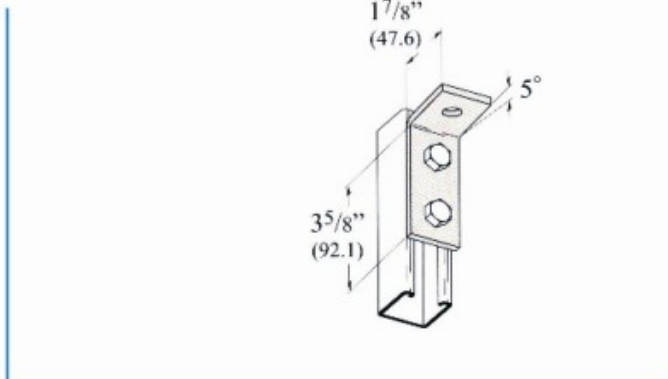

HT-86 TWO HOLE LEG CONNECTION

- Standard finishes : ZN
- Wt /C 100 Lbs. (45.3kg)

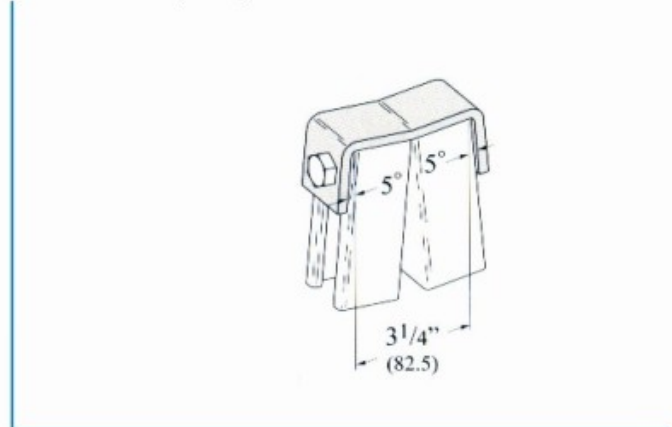

HT-87 TWO HOLE CLOSED ANGLE

- Standard finishes : ZN
- Wt./C 63 Lbs. (28.6 Kg)

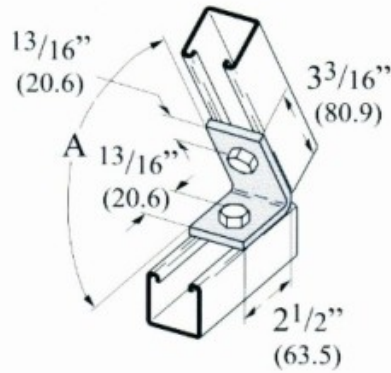

HT-88 TWO HOLE CLOSED ANGLE

- Standard finishes : ZN
- Wt./C 63 Lbs. (28.6 kg)

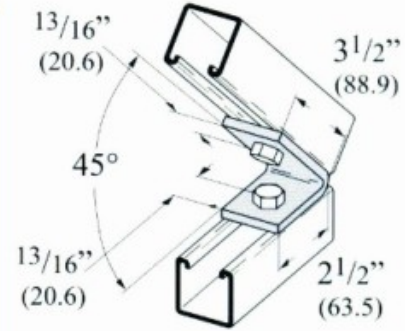

Part No.	A	Wt./ C	
		Lbs.	kg
HT-87A	82 1/2°	56	(25.4)
HT-87B	75°		
HT-87C	67 1/2°		
HT-87D	60°		
HT-87E	52 1/2°		
HT-87F	37 1/2°		

HT-89 FOUR HOLE CLOSED ANGLE

- Standard finishes : ZN

Part No.	A	Wt./ C	
		Lbs.	kg
HT-89A	82 1/2°	95	(43.1)
HT-89B	75°		
HT-89C	67 1/2°		
HT-89D	60°		
HT-89E	52 1/2°		
HT-89F	45°		
HT-89G	37 1/2°		

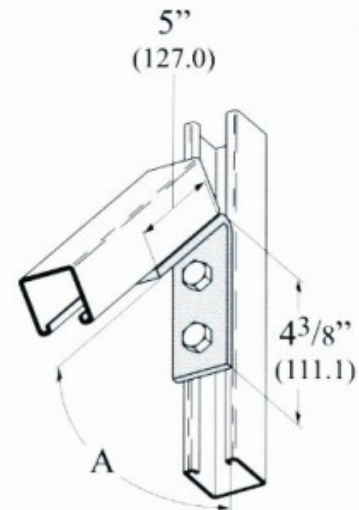

HT-90 TWO HOLE 45° KNEE BRACE

- Standard finishes : ZN
- Do not exceed allowable beam or column loads for strut channels.

Part No.	A	(A)	B	(B)	Design Load		Wt./ C	
					Lbs.	kg	Lbs.	kg
HT-90A	8"	(203.2)	7 3/8"	(187.3)	1500	(6.67)	119	(54.0)
HT-90B	12"	(304.8)	10 1/8"	(257.2)	1020	(4.54)	165	(74.8)
HT-90C	16 5/8"	(422.3)	13 3/8"	(339.7)	530	(2.36)	218	(98.9)
HT-90D	18"	(457.2)	14 7/16"	(366.7)	450	(2.00)	234	(106.1)
HT-90E	24"	(609.6)	18 11/16"	(474.7)	250	(1.11)	303	(137.4)
HT-90F	36"	(914.4)	27 3/16"	(690.6)	110	(.49)	441	(200.0)

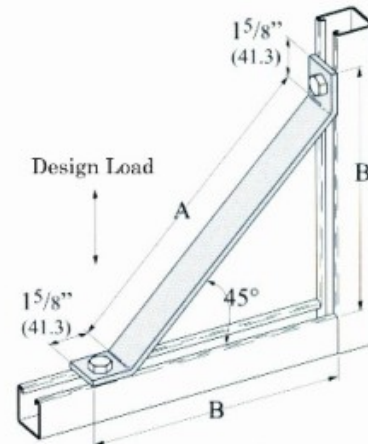

BRACES

HT-91
TWO HOLE SPLICE
CLEVIS FOR B52

- Standard finishes : ZN
- Wt./C 84 Lbs. (38.1 Kg)

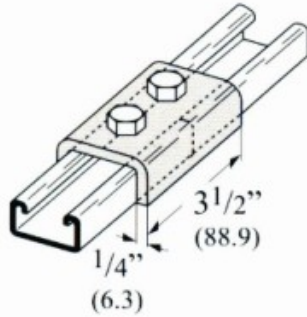

HT-92
THREE HOLE SPLICE
CLEVIS FOR B52

- Standard finishes : ZN
- Wt./C 126 Lbs. (57.1 Kg)

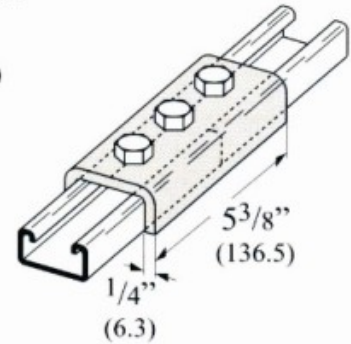

HT-93
FOUR HOLE SPLICE
CLEVIS FOR B52

- Standard finishes : ZN
- Wt./C 178 Lbs. (80.7 Kg)

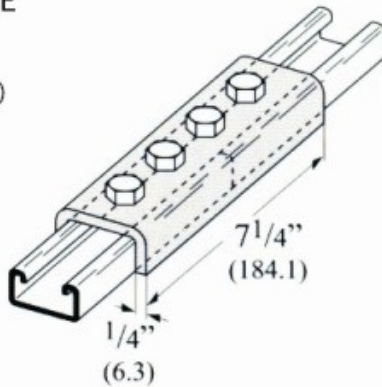

HT-94
TWO HOLE SPLICE
CLEVIS FOR B22 OR B52A

- Standard finishes : ZN
- Wt./C 123 Lbs. (55.8 Kg)

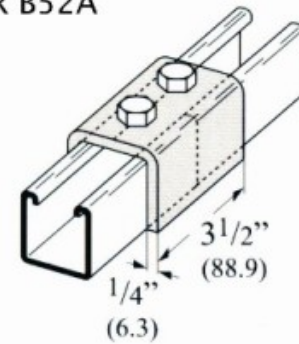

HT-95
THREE HOLE SPLICE
CLEVIS FOR B22 OR B52A

- Standard finishes : ZN
- Wt./C 195 Lbs. (88.4 Kg)

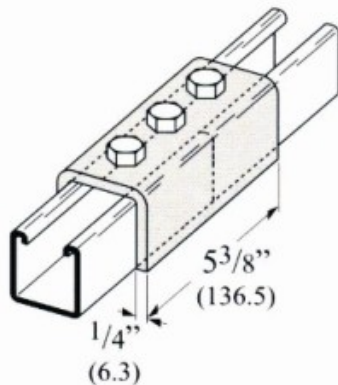

HT-96
FOUR HOLE SPLICE
CLEVIS FOR B22 OR B52 A

- Standard finishes : ZN
- Wt./C 266 Lbs. (120.6 Kg)

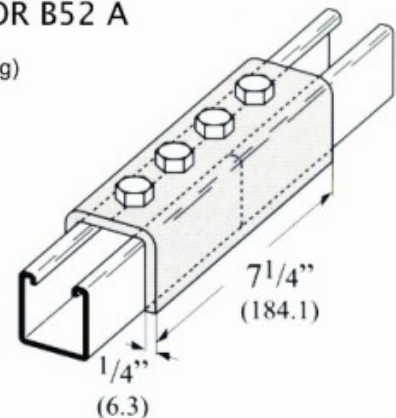

HT-97 U- WASHER

- Standard finishes : ZN

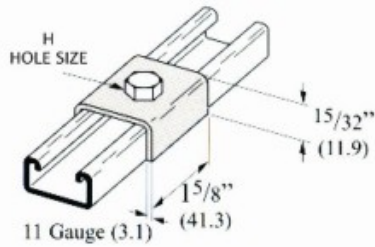

Part No. & Size	Hole Size H		Wt/ C	
			Lbs.	kg
HT-97A- $\frac{1}{2}$	$\frac{9}{16}$ "	(7.9)	14	(6.3)
HT-97B- $\frac{3}{8}$	$\frac{7}{16}$ "	(11.1)	14	(6.3)
HT-97C- $\frac{1}{2}$	$\frac{9}{16}$ "	(14.3)	13	(5.8)
HT-97D- $\frac{5}{8}$	$\frac{11}{16}$ "	(17.4)	13	(5.8)
HT-97E- $\frac{3}{4}$	$\frac{13}{16}$ "	(20.6)	13	(5.8)

HP-1 THREE HOLE OFFSET PLATE CONNECTION

- Standard finishes : ZN
- Wt./C 54 Lbs. (24.5 Kg)

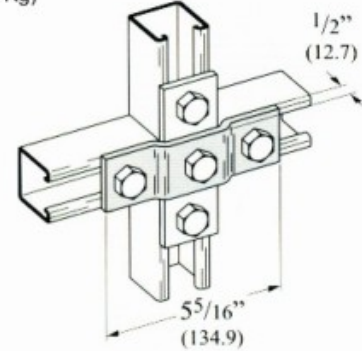

HP-2 THREE HOLE U-SUPPORT

- Standard finishes : ZN
- Wt./C 70 Lbs. (31.7 Kg)

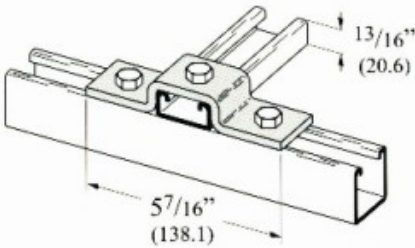

HP-3 THREE HOLE U-SUPPORT

- Standard finishes : ZN
- Wt./C 75 Lbs. (34.0 Kg)

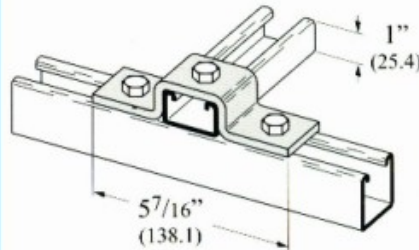

HP-4 THREE HOLE U-SUPPORT

- Standard finishes : ZN
- Wt./C 84 Lbs. (38.1 Kg)

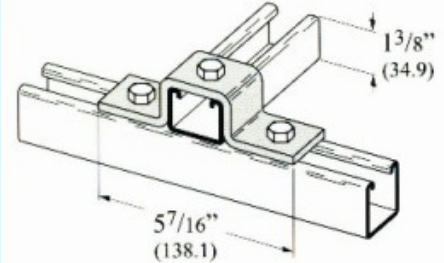

HP-5 FIVE HOLE U-SUPPORT

- Standard finishes : ZN
- Wt./C 85 Lbs. (38.5 Kg)

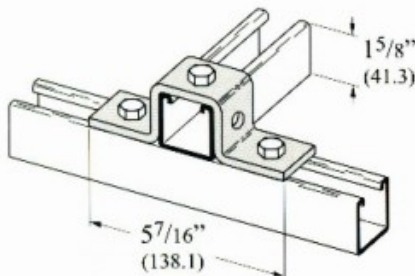

HP-6 THREE HOLE OFFSET U-SUPPORT

- Standard finishes : ZN
- Wt./C 89 Lbs. (40.3 Kg)

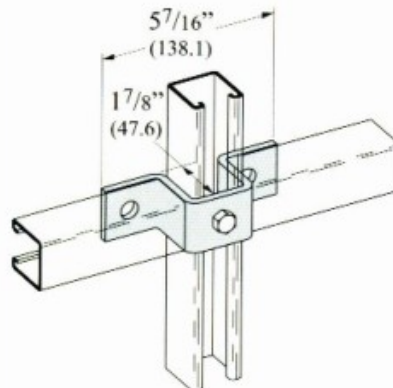

HP-7 FIVE HOLE U-SUPPORT

- Material: 7 Gauge (4.5)
- Standard finishes : ZN
- Wt./C 51 Lbs. (23.1 Kg)

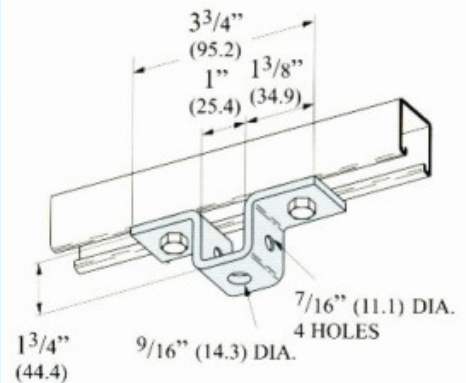

HP-8 THREE HOLE SWIVEL CLEVIS

- Standard finishes : ZN
- Wt./C 53 Lbs. (24.0 Kg)

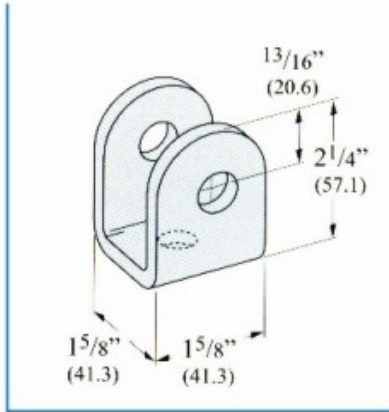

HP-9 THREE HOLE LIGHT-WEIGHT U-SUPPORT

- Material: 10 Gauge (3.4)
- Standard finishes : ZN
- Wt./C 18 Lbs. (8.1 Kg)

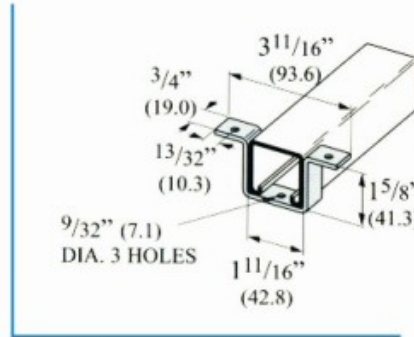

HP-10 FIVE HOLE U-SUPPORT

- Standard finishes : ZN
- Wt./C 106 Lbs. (48.1 Kg)

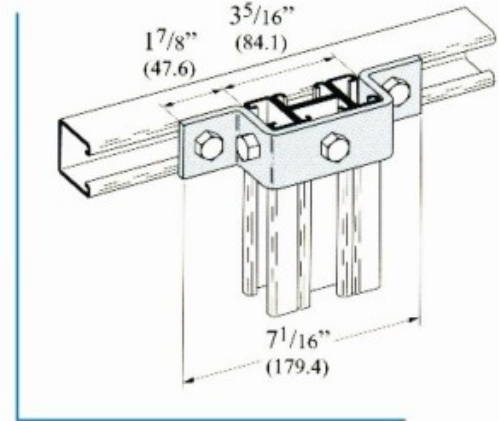

HP-11 SIX HOLE U-SUPPORT

- Standard finishes : ZN
- Wt./C 105 Lbs. (47.6 Kg)

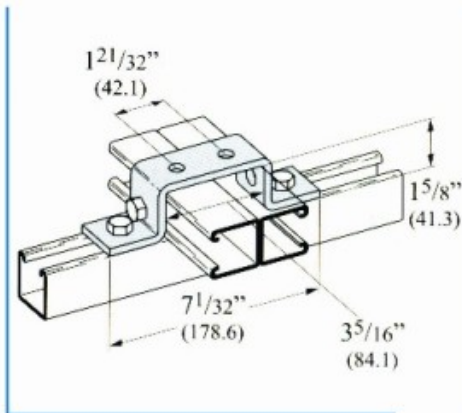

HP-12 SIX HOLE U-SUPPORT

- Standard finishes : ZN
- Wt./C 167 Lbs. (75.7 Kg)

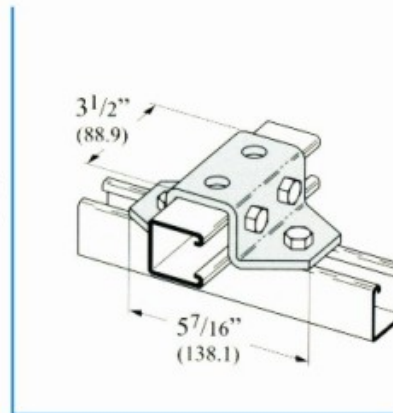

HP-13 EIGHT HOLE U-SUPPORT

- Standard finishes : ZN
- Wt./C 201 Lbs. (91.2 Kg)

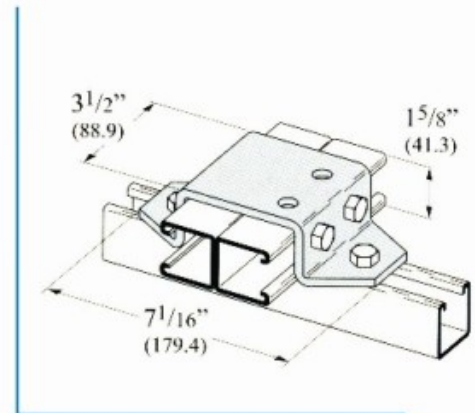

HP-14 SLOTTED THREE HOLE U-SUPPORT

- Standard finishes : ZN

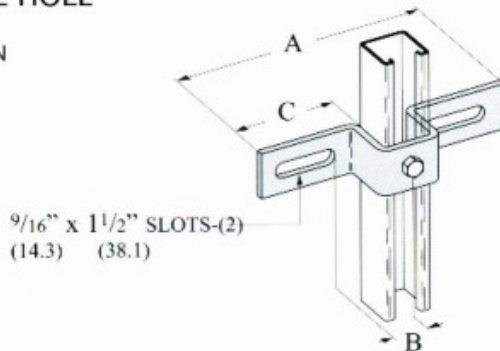

HP-15 SLOTTED THREE HOLE U-SUPPORT WITH GUSSET

- Consists of HP-14 A, B, or C with gusset plate welded on back.
- Standard finishes : ZN

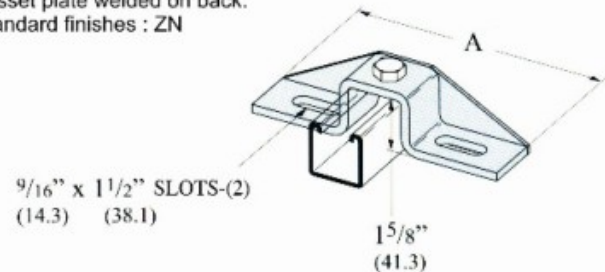

Part No.	A	(A)	B	(B)	C	(C)	Wt./C
							Lbs. kg
HP-14A	7 1/2"	(190.5)	1 5/16"	(33.3)	2 7/8"	(73.0)	103 (46.7)
HP-14B	8 1/2"	(215.9)	1 9/16"	(49.2)	3 3/8"	(85.7)	115 (52.1)
HP-14C	10 3/8"	(263.5)	2 5/8"	(73.0)	4 5/16"	(109.5)	135 (61.2)

Part No.	A	(A)	Wt./C
			Lbs. kg
HP-15A	7 1/2"	(190.5)	137 (62.1)
HP-15B	8 1/2"	(215.9)	156 (70.7)
HP-15C	10 3/8"	(263.5)	172 (78.0)

HP-16
TWO HOLE BUS DUCT CLEVIS
Standard finishes : ZN

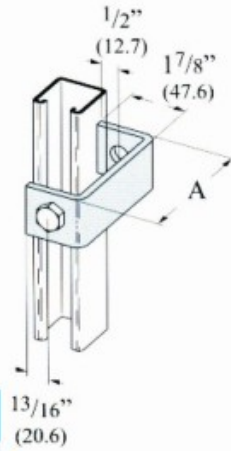

Part No.	A	(A)	Wt./C	
			Lbs.	kg
HP-16A	2 ³ / ₃₂ "	(61.1)	58	(26.3)
HP-16B	3 ³ / ₃₂ "	(96.0)	76	(34.5)
HP-16C	4 ³ / ₄ "	(120.65)	88	(39.9)

HP-17
TWO HOLE CLEVIS
Standard finishes : ZN

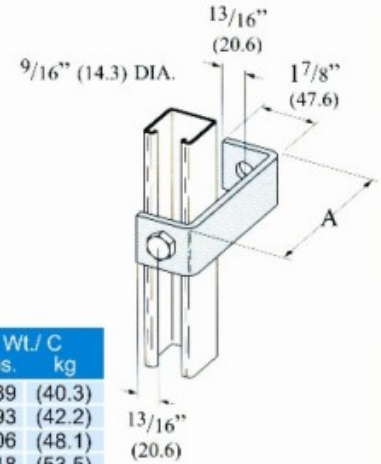

Part No.	A	(A)	Wt./C	
			Lbs.	kg
HP-17A	4"	(101.6)	89	(40.3)
HP-17B	5"	(127.0)	93	(42.2)
HP-17C	6"	(152.4)	106	(48.1)
HP-17D	7"	(177.8)	118	(53.5)
HP-17E	8"	(203.2)	132	(59.9)

HP-18
FOUR HOLE CLEVIS
• Standard finishes : ZN
• Wt./C 71 Lbs. (32.2 Kg)

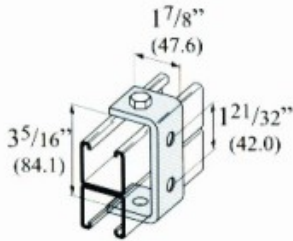

HP-19
THREE HOLE CLEVIS
• Standard finishes : ZN
• Wt./C 75 Lbs. (34.0 Kg)

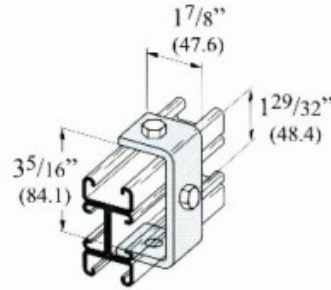

HP-20
THREE HOLE SUSPENSION CLEVIS
• Standard finishes : ZN
• Wt./C 75 Lbs. (34.0 Kg)

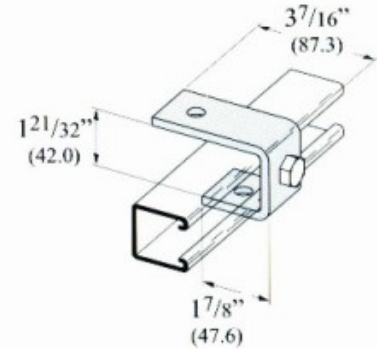

HP-21
THREE HOLE CUP SUPPORT
• Standard finishes : ZN
• Wt./C 88 Lbs. (39.9 Kg)

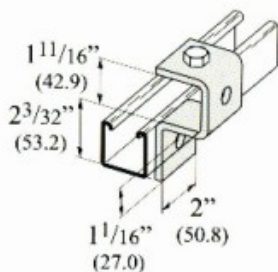

HP-22
THREE HOLE CUP SUPPORT
• Standard finishes : ZN
• Wt./C 73 Lbs. (33.1 Kg)H

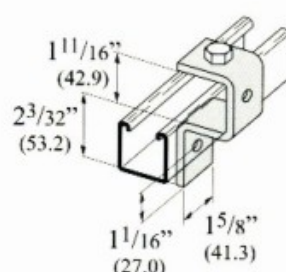

HP-23
TWO HOLE BUS DUCT CONNECTION
• Standard finishes : ZN
• Wt./C 56 Lbs. (25.4 Kg)

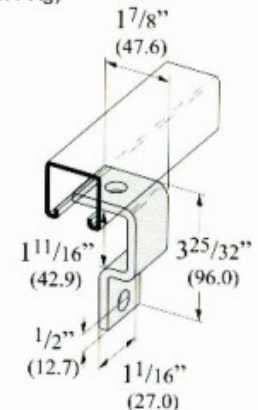

HP-24
THREE STUD
RING CONNECTION

- ½" - 13 stud protrudes 1"
- Standard finishes : ZN
- Wt./C 85 Lbs. (38.5 Kg)

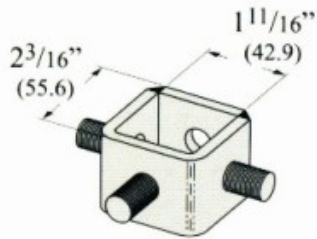

HP-25
ONE STUD
RING CONNECTION

- ½" - 13 stud protrudes 1"
- Standard finishes : ZN
- Wt./C 53 Lbs. (24.0 Kg)

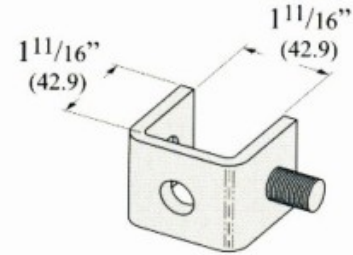

HP-26
ONE STUD
RING CONNECTION

- ½" - 13 stud protrudes 1"
- Standard finishes : ZN
- Wt./C 40 Lbs. (18.1 Kg)

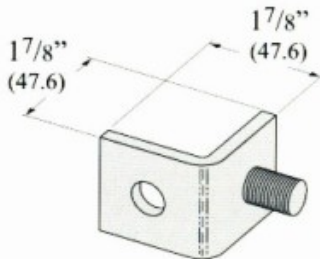

HP-27
TWO STUD
RING CONNECTION

- ½" - 13 stud protrudes 1"
- Standard finishes : ZN
- Wt./C 59 Lbs. (26.7 Kg)

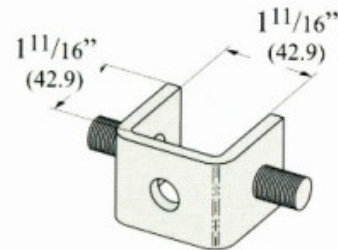

HP-28
TWO STUD
RING CONNECTION

- ½" - 13 stud protrudes 1"
- Standard finishes : ZN
- Wt./C 59 Lbs. (26.7 Kg)

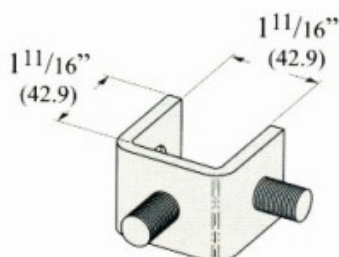

HP-29
TAPPED U-SUPPORT

- Standard finishes : ZN
- Wt./C 87 Lbs. (39.4 Kg)

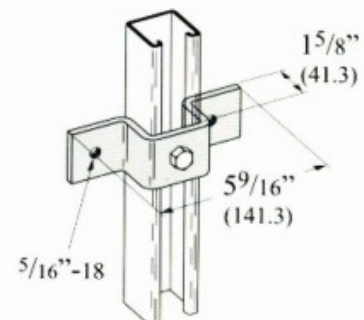

**HPZ-1
TWO HOLE
OFFSET Z-SUPPORT**

- Standard finishes : ZN
- Wt./C 38 Lbs. (17.2 Kg)

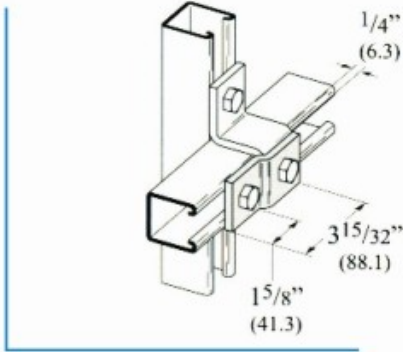

**HPZ-2
TWO HOLE
Z-SUPPORT**

- Standard finishes : ZN
- Wt./C 40 Lbs. (18.1 Kg)

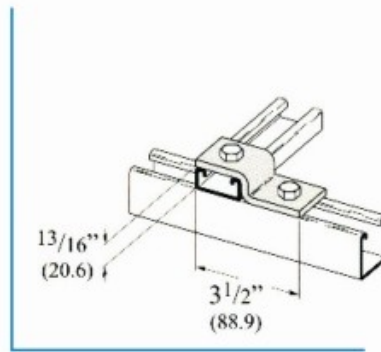

**HPZ-3
TWO HOLE
Z-SUPPORT**

- Standard finishes : ZN
- Wt./C 44 Lbs. (20.0 Kg)

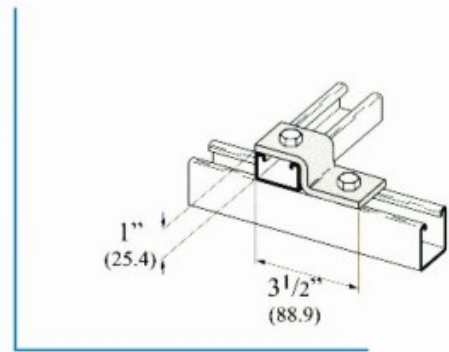

**HPZ-4
TWO HOLE
Z-SUPPORT**

- Standard finishes : ZN
- Wt./C 51 Lbs. (23.1 Kg)

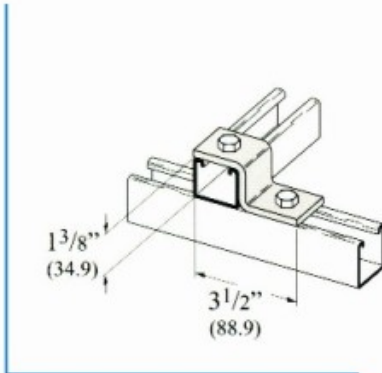

**HPZ-5
TWO HOLE
Z-SUPPORT**

- Standard finishes : ZN
- Wt./C 63 Lbs. (28.6 Kg)

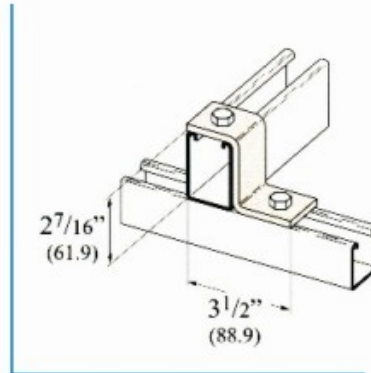

**HPZ-6
THREE HOLE
Z-SUPPORT**

- Standard finishes : ZN
- Wt./C 51 Lbs. (23.1 Kg)

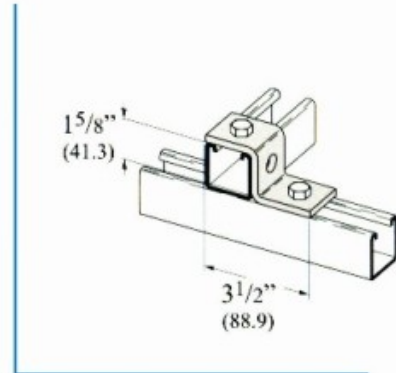

**HPZ-7
THREE HOLE
Z-SUPPORT**

- Standard finishes : ZN
- Wt./C 70 Lbs. (31.7 Kg)

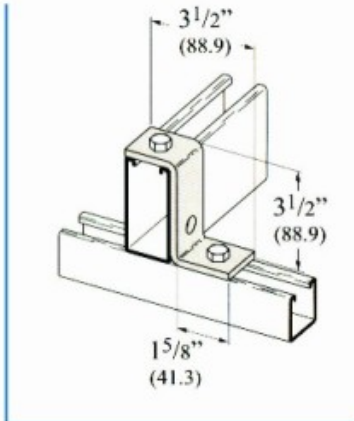

**HPZ-8
TWO HOLE
Z-SUPPORT**

- Standard finishes : ZN
- Wt./C 90 Lbs. (40.8 Kg)

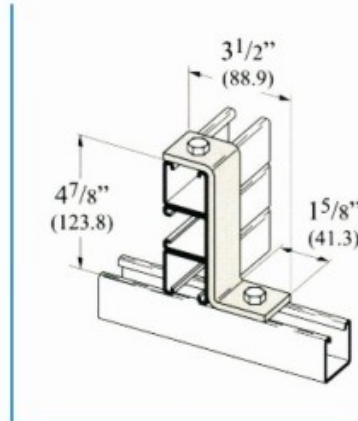

**HPZ-9
TWO HOLE
OFFSET Z-SUPPORT**

- Standard finishes : ZN
- Wt./C 55 Lbs. (24.9 Kg)

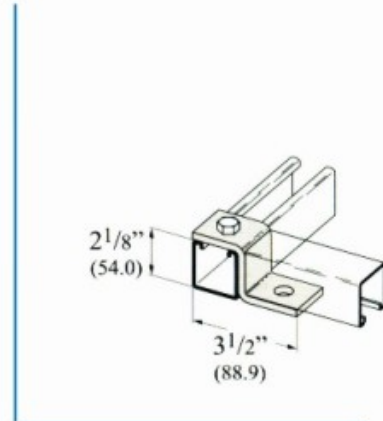

HPZ-10 TWO HOLE Z-BUS DUCT CONNECTION

- Standard finishes : ZN

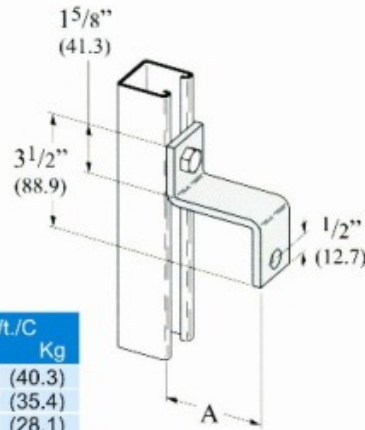

Part No.	A	(A)	Wt./C	
			Lbs.	Kg
HPZ-10A	4 3/4"	(120.6)	89	(40.3)
HPZ-10B	3 5/8"	(96.0)	78	(35.4)
HPZ-10C	2 13/16"	(61.1)	62	(28.1)

HPZ-11 TWO HOLE Z-SUPPORT

- Standard finishes : ZN

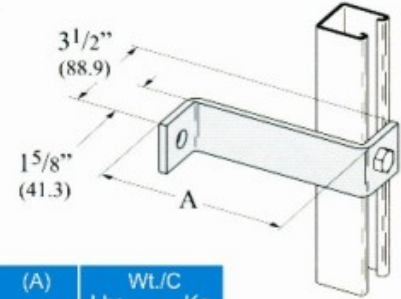

Part No.	A	(A)	Wt./C	
			Lbs.	Kg
HPZ-11A	4"	(101.6)	77	(34.9)
HPZ-11B	5"	(127.0)	95	(43.1)
HPZ-11C	6"	(152.4)	98	(44.4)
HPZ-11D	7"	(177.8)	105	(47.6)
HPZ-11E	8"	(203.2)	120	(54.4)

HPZ-12 TAPPED Z-SUPPORT

- Standard finishes : ZN
- Wt./C 51 Lbs. (23.1 Kg)

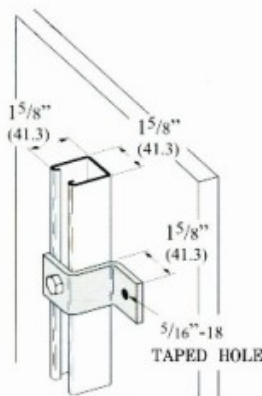

HPZ-13 TAPPED Z-SUPPORT

- Standard finishes : ZN
- Wt./C 50 Lbs. (22.7 Kg)

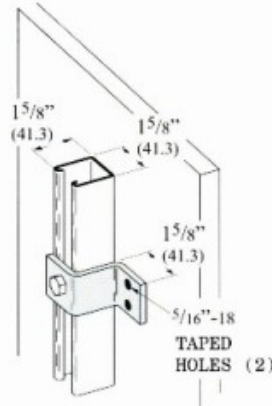

HPZ-14 THREE HOLE SHEATH CORNER CONNECTION

- Standard finishes : ZN
- Wt./C 68 Lbs. (30.8 Kg)

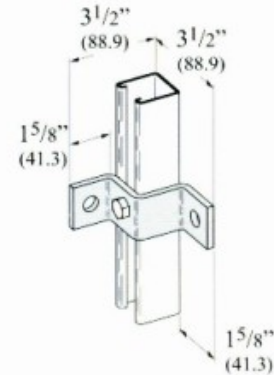

HPZ-15 TAPPED CORNER CONNECTION

- Standard finishes : ZN
- Wt./C 71 Lbs. (32.2 Kg)

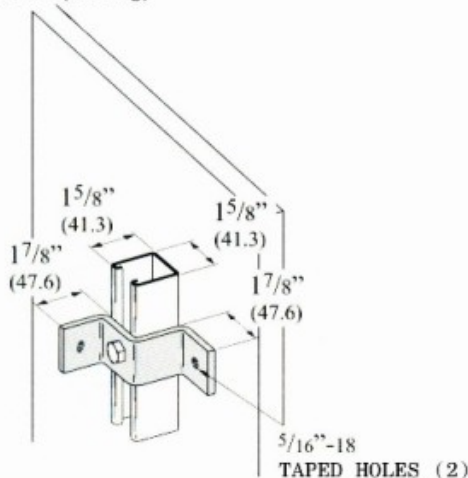

HPZ-16 TAPPED CORNER CONNECTION

- Standard finishes : ZN
- Wt./C 68 Lbs. (30.8 Kg)

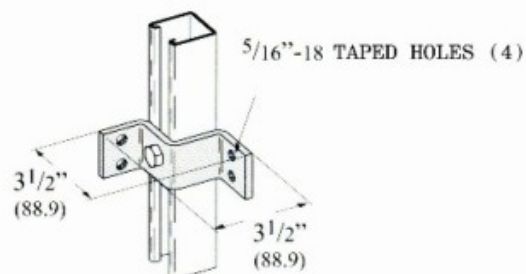

HPZ-17 CHANNEL HANGER BRACKET

- Material: 11 Gauge(3.0)
- Standard finishes : ZN
- Wt./C 6.7 Lbs. (3.0 Kg)

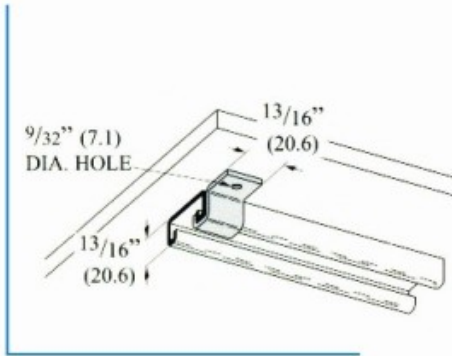

HPZ-18 CHANNEL HANGER BRACKET

- Material: 11 Gauge(3.0)
- Standard finishes : ZN
- Wt./C 8.3 Lbs. (3.7 Kg)

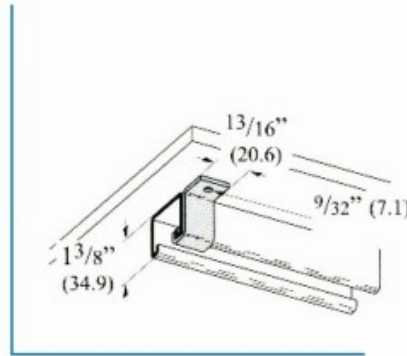

HPZ-19 CHANNEL HANGER BRACKET

- Material: 11 Gauge(3.0)
- Standard finishes : ZN
- Wt./C 9 Lbs. (4.1 Kg)

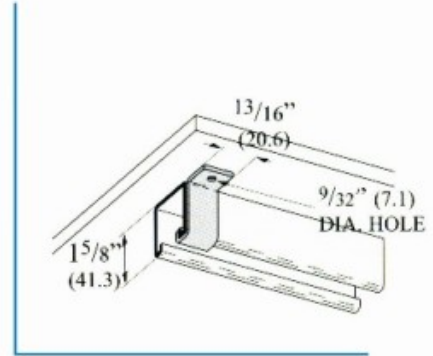

HPZ-20 CHANNEL HANGER BRACKET

- Material: 11 Gauge(3.0)
- Standard finishes : ZN
- Wt./C 11.2 Lbs. (5.1 Kg)

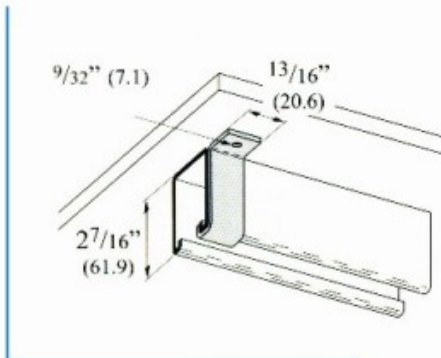

HPZ-21 CHANNEL HANGER BRACKET

- Material: 11 Gauge(3.0)
- Standard finishes : ZN
- Wt./C 13.4 Lbs. (6.1 Kg)

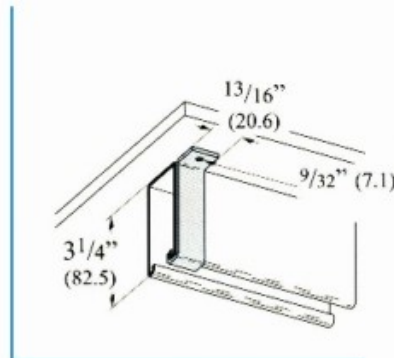

HPZ-22 FIVE HOLE GUSSETED Z-SUPPORT

- Material: 11 Gauge(3.0)
- Standard finishes : ZN
- Wt./C 100 Lbs. (45.3 Kg)

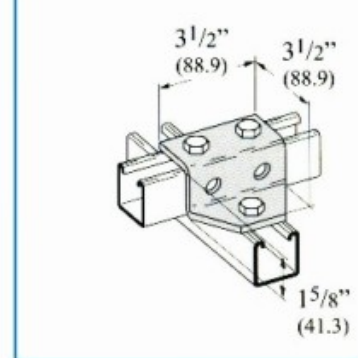

HPZ-23 ADJUSTABLE OFFSET GUSSETED Z-SUPPORT

- Standard finishes : ZN
- Wt./C 93 Lbs. (42.2 Kg)

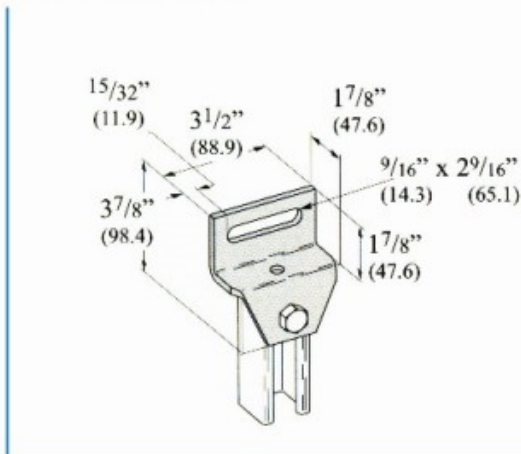

HPZ-24 EIGHT HOLE GUSSETED CORNER CONNECTION

- Standard finishes : ZN
- Wt./C 203 Lbs. (92.1 Kg)

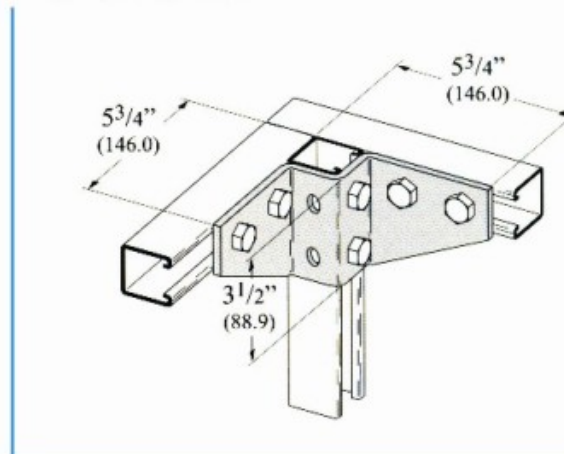

HPW -1
THREE HOLE SINGLE CORNER CONNECTION (RIGHT HAND)

- Standard finishes : ZN
- Wt./C 54 Lbs. (24.5 Kg)

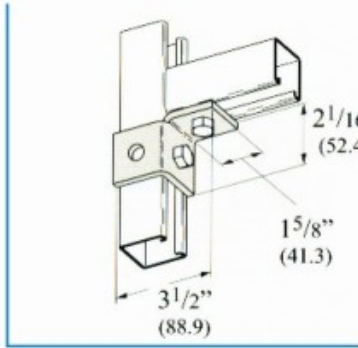

HPW -2
THREE HOLE SINGLE CORNER CONNECTION (LEFT HAND)

- Standard finishes : ZN
- Wt./C 54 Lbs. (24.5 Kg)

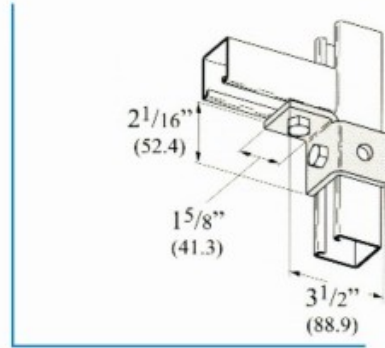

HPW -3
FOUR HOLE SINGLE CORNER CONNECTION (RIGHT HAND)

- Standard finishes : ZN
- Wt./C 77 Lbs. (34.9 Kg)

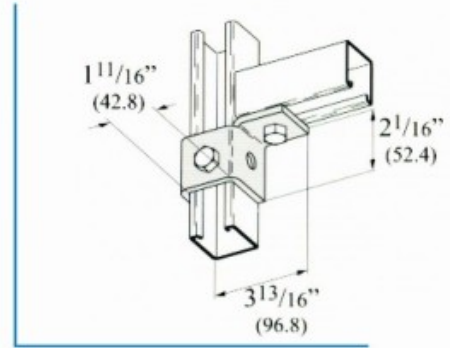

HPW -4
FOUR HOLE SINGLE CORNER CONNECTION (LEFT HAND)

- Standard finishes : ZN
- Wt./C 77 Lbs. (34.9 Kg)

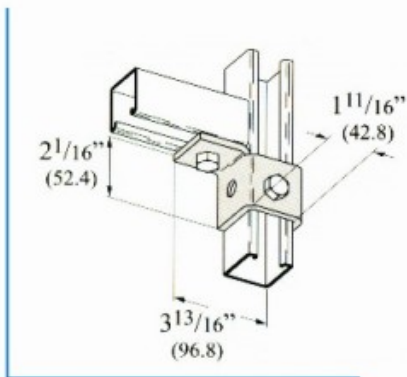

HPW -5
FIVE HOLE SINGLE CORNER CONNECTION (RIGHT HAND)

- Standard finishes : ZN
- Wt./C 100 Lbs. (45.3 Kg)

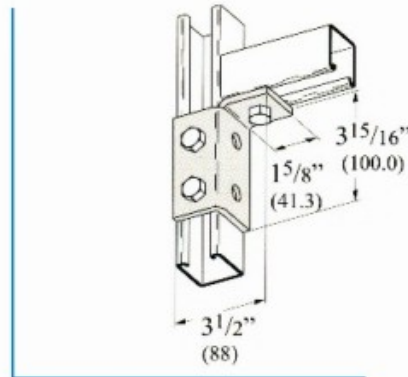

HPW -6
FIVE HOLE SINGLE CORNER CONNECTION (LEFT HAND)

- Standard finishes : ZN
- Wt./C 100 Lbs. (45.3 Kg)

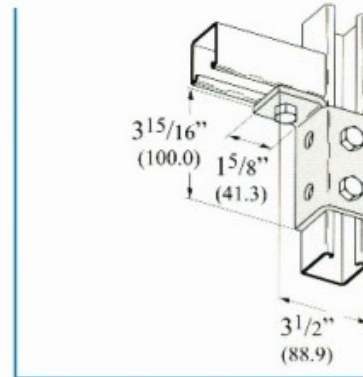

HPW -7
SIX HOLE SINGLE CORNER CONNECTION (RIGHT HAND)

- Standard finishes : ZN
- Wt./C 120 Lbs. (54.4 Kg)

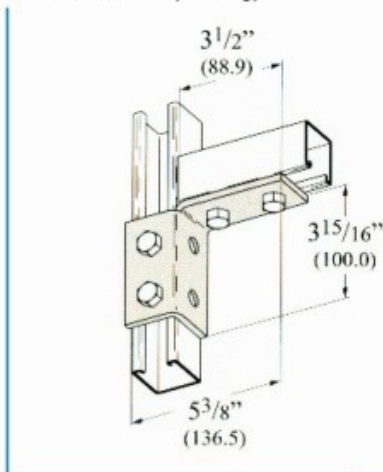

HPW -8
SIX HOLE SINGLE CORNER CONNECTION (LEFT HAND)

- Standard finishes : ZN
- Wt./C 120 Lbs. (54.4 Kg)

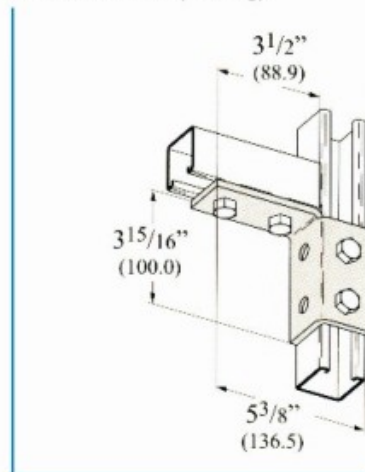

HPW -9
FOUR HOLE DOUBLE CORNER CONNECTION

- Standard finishes : ZN
- Wt./C 71 Lbs. (32.2 Kg)

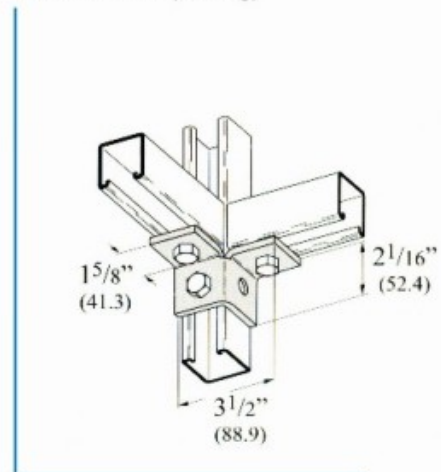

HPW -10
SIX HOLE DOUBLE
CORNER CONNECTION

- Standard finishes : ZN
- Wt./C 110 Lbs. (49.9 Kg)

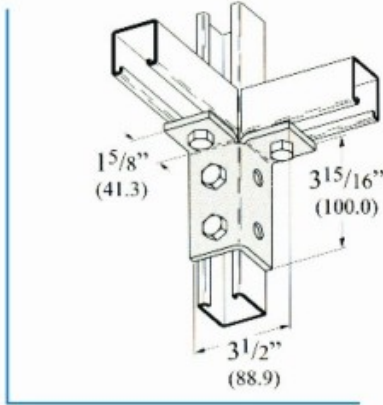

HPW -11
EIGHT HOLE DOUBLE
CORNER CONNECTION

- Standard finishes : ZN
- Wt./C 152 Lbs. (68.9 Kg)

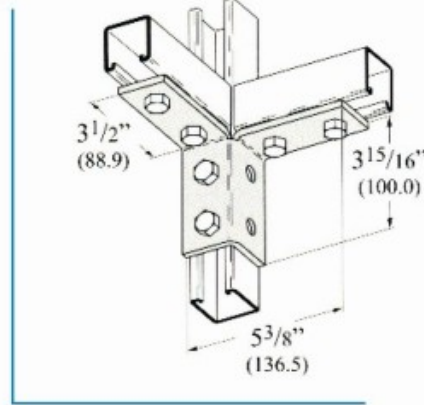

HPW -12
FIVE HOLE DOUBLE
WING CONNECTION

- Standard finishes : ZN
- Wt./C 95 Lbs. (43.1 Kg)

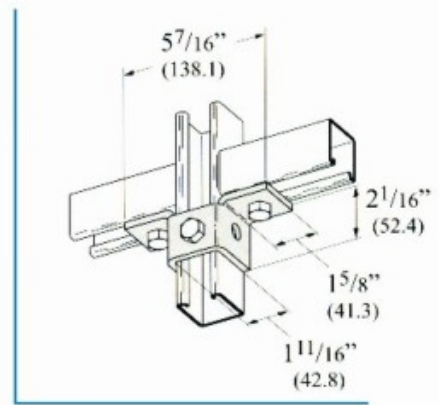

HPW -13
EIGHT HOLE DOUBLE
WING CONNECTION

- Standard finishes : ZN
- Wt./C 156 Lbs. (70.7 Kg)

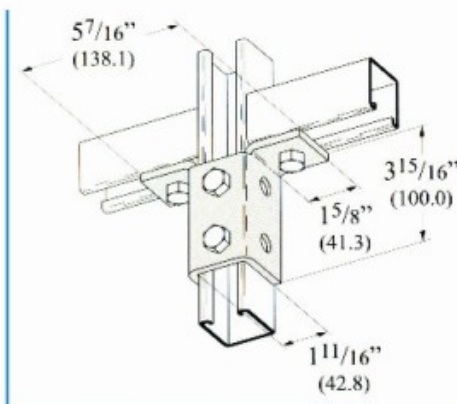

HPW -14
TEN HOLE DOUBLE
WING CONNECTION

- Standard finishes : ZN
- Wt./C 185 Lbs. (83.9 Kg)

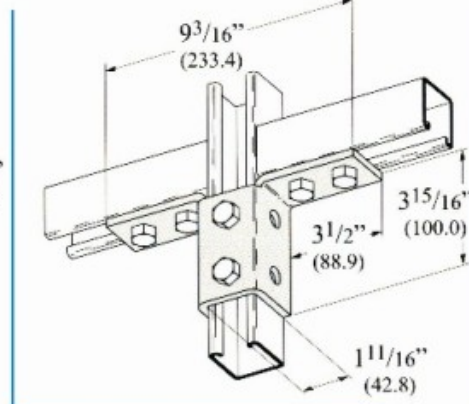

HPW -15
SIX HOLE TRIPLE
WING CONNECTION

- Standard finishes : ZN
- Wt./C 110 Lbs. (49.9 Kg)

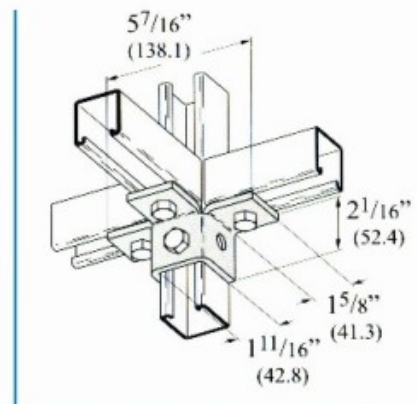

HPW -16
TWELVE HOLE TRIPLE
WING CONNECTION

- Standard finishes : ZN
- Wt./C 234 Lbs. (106.1 Kg)

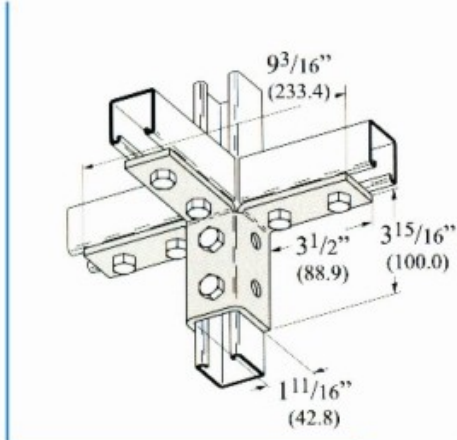

HPW -17
NINE HOLE TRIPLE
WING CONNECTION

- Standard finishes : ZN
- Wt./C 177 Lbs. (80.3 Kg)

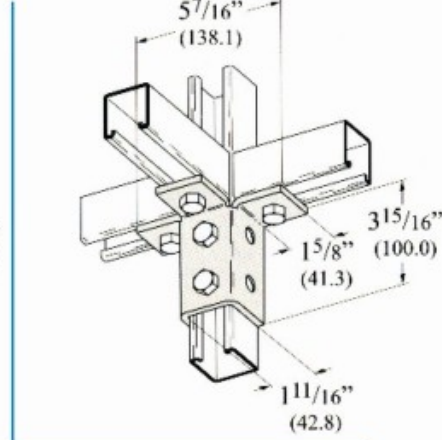

HPW -18
DOUBLE CORNER
GUSSETED CONNECTION

- Standard finishes : ZN
- Wt./C 196 Lbs. (88.9 Kg)

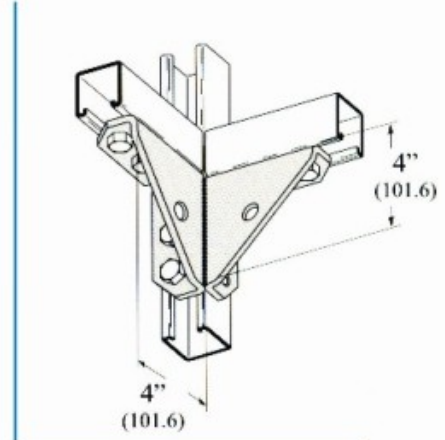

HPW -19
EIGHT HOLE SINGLE CORNER
GUSSETTED CONNECTION
(RIGHT HAND)

- Standard finishes : ZN
- Wt./C 176 Lbs. (79.8 Kg)

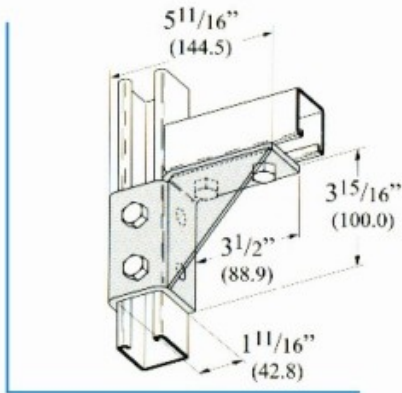

HPW -20
EIGHT HOLE SINGLE CORNER
GUSSETTED CONNECTION
(LEFT HAND)

- Standard finishes : ZN
- Wt./C 176 Lbs. (79.8 Kg)

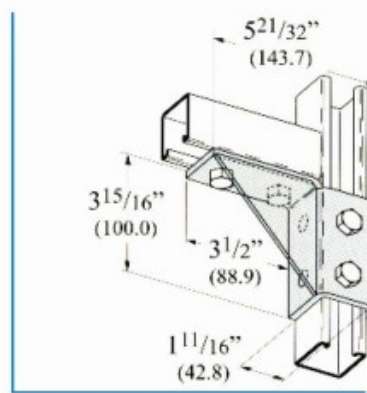

HPW -21
TEN HOLE DOUBLE WING
GUSSETTED CONNECTION

- Standard finishes : ZN
- Wt./C 240 Lbs. (108.8 Kg)

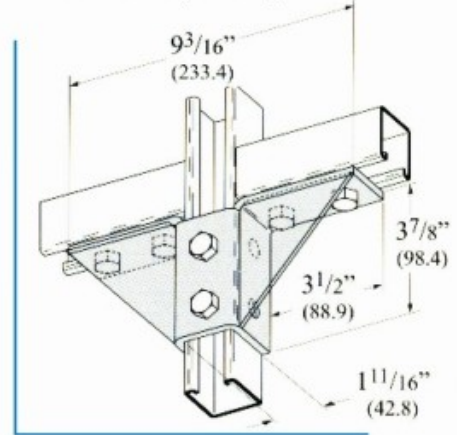

HPW -22
TWELVE HOLE TRIPLE WING
GUSSETTED CONNECTION

- Standard finishes : ZN
- Wt./C 285 Lbs. (129.3 Kg)

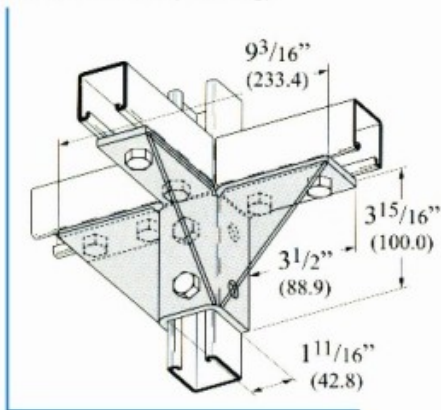

HPW -23
TEN HOLE DOUBLE CORNER
GUSSETTED CONNECTION

- Standard finishes : ZN
- Wt./C 226 Lbs. (102.5 Kg)

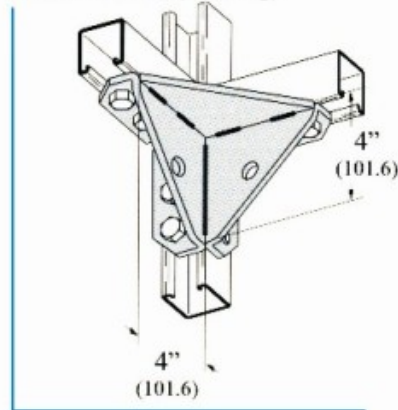

HPW -24
EIGHT HOLE WING
CONNECTION

- Standard finishes : ZN
- Wt./C 201 Lbs. (91.2 Kg)

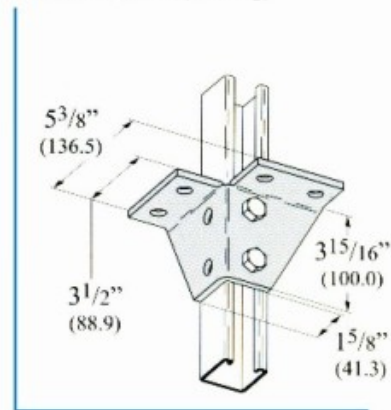

HPW -25
EIGHT HOLE DOUBLE CORNER
GUSSETTED CONNECTION (LEFT HAND)

- Standard finishes : ZN
- Wt./C 242 Lbs. (109.8 Kg)

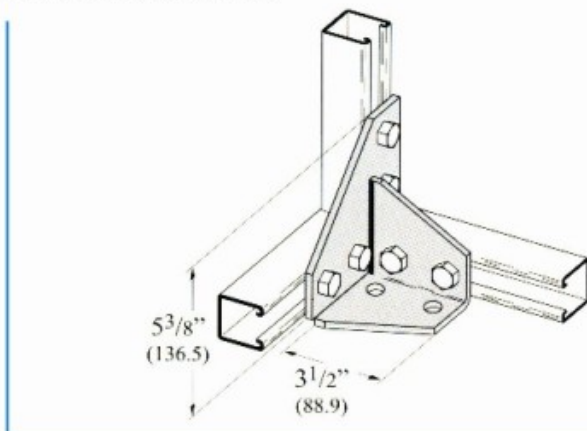

HPW -26
EIGHT HOLE DOUBLE CORNER
GUSSETTED CONNECTION (RIGHT HAND)

- Standard finishes : ZN
- Wt./C 242 Lbs. (109.8 Kg)

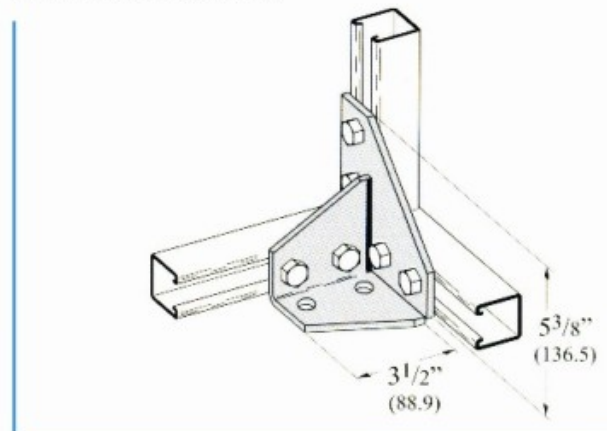

HPB - 1

- Standard finishes : ZN
- Wt./C 314 Lbs. (142.4 Kg)

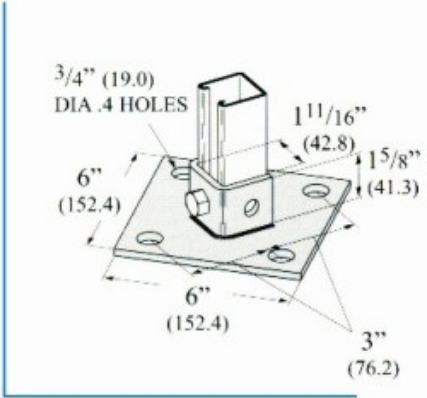

HPB - 2

- Standard finishes : ZN
- Wt./C 314 Lbs. (142.4 Kg)

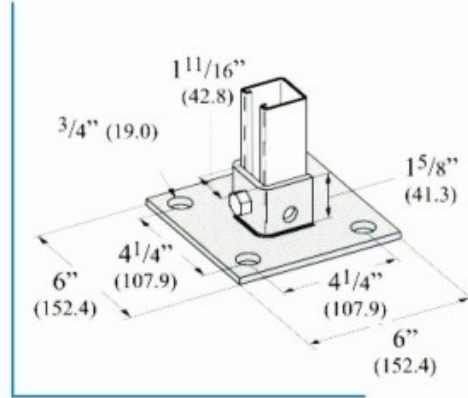

HPB - 3

- Standard finishes : ZN
- Wt./C 230 Lbs. (104.3 Kg)

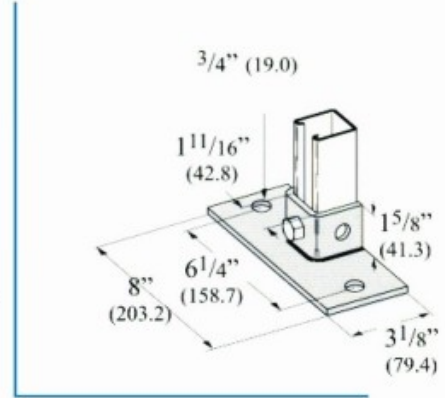

HPB - 4

- Standard finishes : ZN
- Wt./C 392 Lbs. (177.8 Kg)

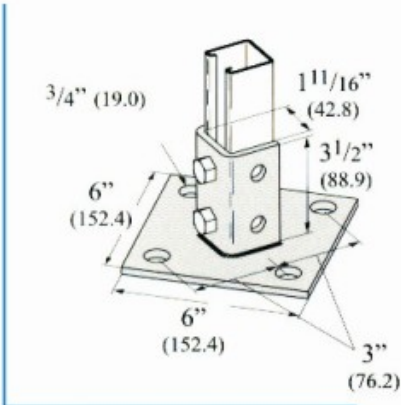

HPB - 5

- Standard finishes : ZN
- Wt./C 392 Lbs. (177.8 Kg)

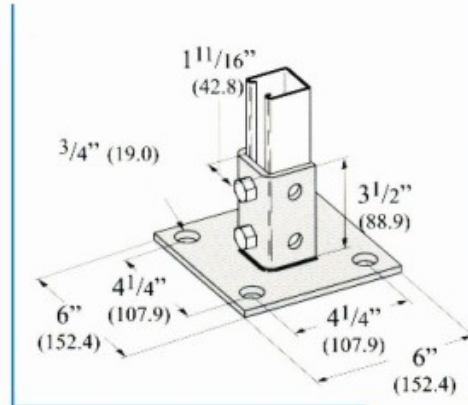

HPB - 6

- Standard finishes : ZN
- Wt./C 312 Lbs. (141.5 Kg)

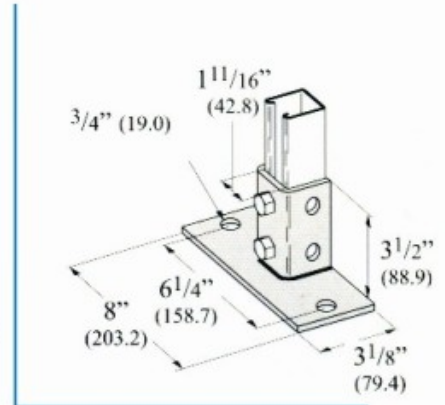

HPB - 7

- Standard finishes : ZN
- Wt./C 330 Lbs. (149.7 Kg)

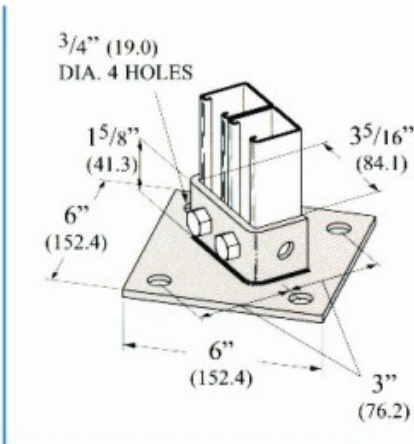

HPB - 8

- Standard finishes : ZN
- Wt./C 330 Lbs. (149.7 Kg)

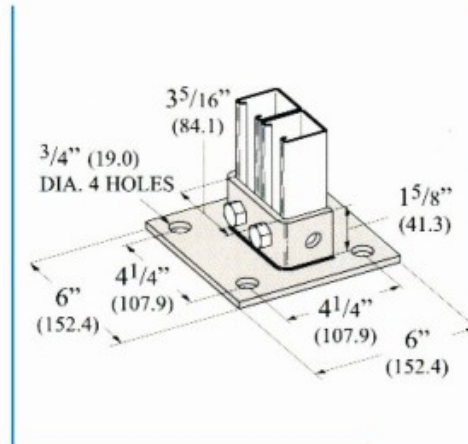

HPB - 9

- Standard finishes : ZN
- Wt./C 250 Lbs. (113.4 Kg)

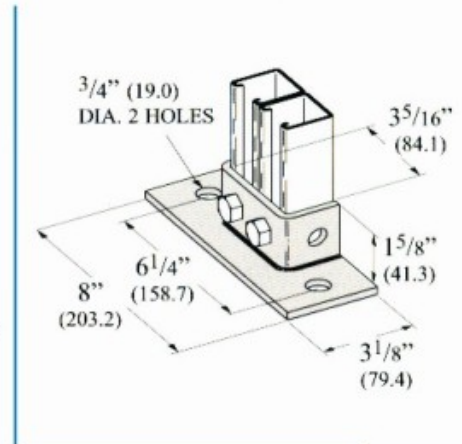

HPB - 10

- Standard finishes : ZN
- Wt./C 400 Lbs. (181.4 Kg)

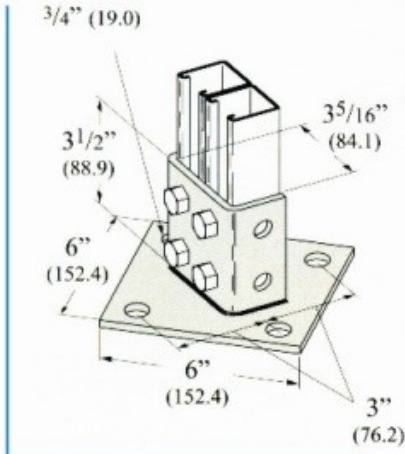

HPB - 11

- Standard finishes : ZN
- Wt./C 400 Lbs. (181.4 Kg)

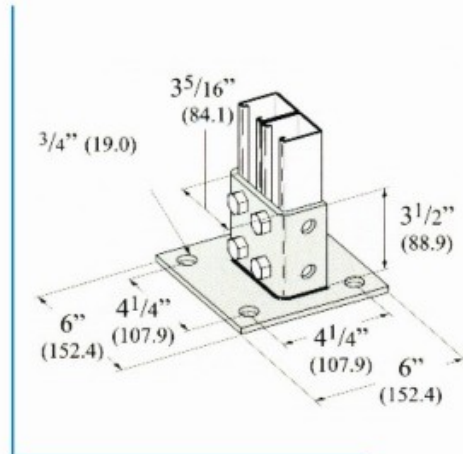

HPB - 12

- Standard finishes : ZN
- Wt./C 320 Lbs. (145.1 Kg)

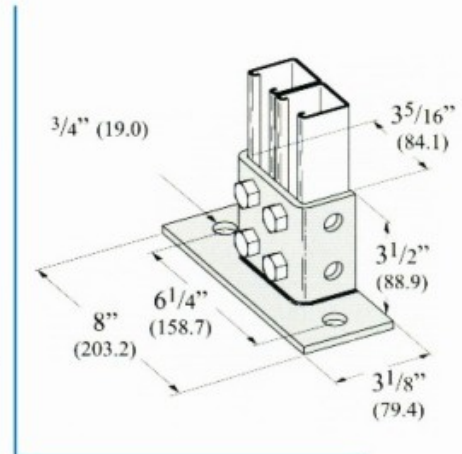

HPB - 13

- Standard finishes : ZN
- Wt./C 470 Lbs. (213.2 Kg)

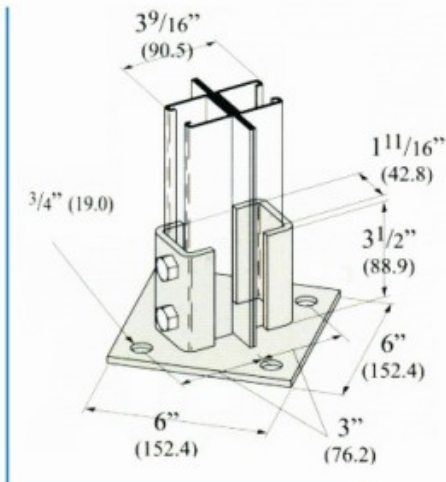

HPB - 14

- Standard finishes : ZN
- Wt./C 470 Lbs. (213.2 Kg)

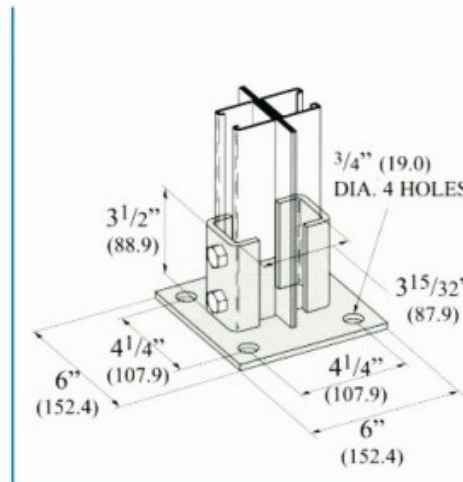

HPB - 15

CHANNEL COMBINATIONS

- Standard finishes : ZN
- Wt./C 397 Lbs. (180.1 Kg)

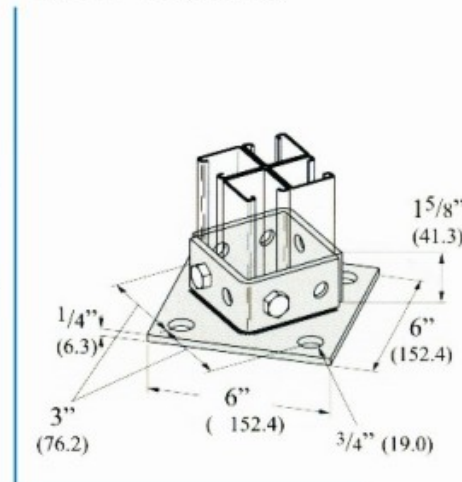

HPB - 16

CHANNEL COMBINATIONS

- Standard finishes : ZN
- Wt./C 550 Lbs. (249.5 Kg)

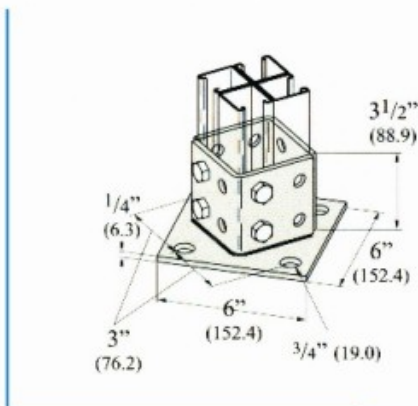

HPB - 17

- Standard finishes : ZN
- Wt./C 288 Lbs. (130.6 Kg)

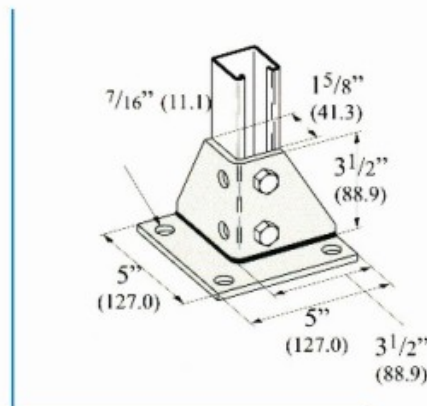

HPB - 18

- Standard finishes : ZN
- Wt./C 97 Lbs. (44.0 Kg)

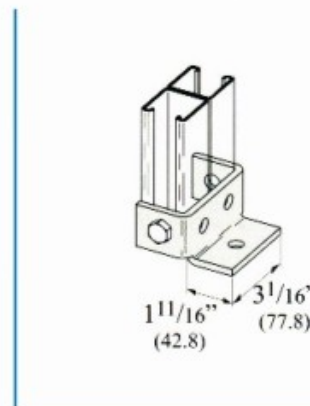

Cantilever Bracket

HCB - 1

Cantilever Bracket

HCB - 2

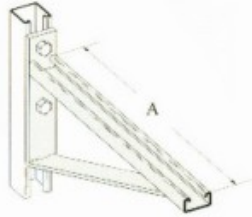

Catalog No.	Uniform Load Lbs.	Uniform Load kN	Tray Width		A	
			in.	mm	in.	mm
HCB-1A	1580	7.02	6 & 9	152 & 229	12	304.8
HCB-1B	830	3.69	12	305	18	457.2
HCB-1C	830	3.69	18	457	24	609.6

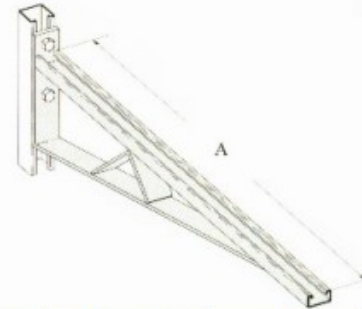

Catalog No.	Uniform Load Lbs.	Uniform Load kN	Tray Width		A	
			in.	mm	in.	mm
HCB-2A	750	3.33	24	609.6	30	762.0
HCB-2B	665	2.95	30	762.0	36	914.4
HCB-2C	580	2.58	36	914.4	42	1066.8

Cantilever Bracket

HCB - 3

Cantilever Bracket

HCB - 4



Catalog No.	Uniform Load Lbs.	Uniform Load kN	Tray Width		A	
			in.	mm	in.	mm
HCB-3A	800	3.5	6 & 9	152 & 229	12	304.8
HCB-3B	530	2.35	12	305	18	457.2
HCB-3C	400	1.78	18	457	24	609.6

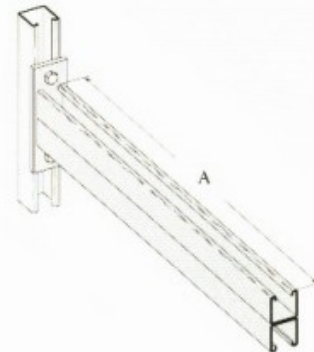

Catalog No.	Uniform Load Lbs.	Uniform Load kN	Tray Width		A	
			in.	mm	in.	mm
HCB-4A	665	2.95	24	609.6	30	762.0
HCB-4B	550	2.44	30	762.0	36	914.4
HCB-4C	465	2.06	36	914.4	42	1066.8

Underfloor Support

HCB - 5

Cantilever Bracket

HCB - 6

U-Bolt Size	Fits Pipe O. D.
H501- 3/4	.841 - 1.050
H501-1	1.051 - 1.351
H501-1 1/4	1.316 - 1.660
H501-1 1/2	1.661 - 1.900
H501-2	1.901 - 2.375
H501-2 1/2	2.376 - 2.875

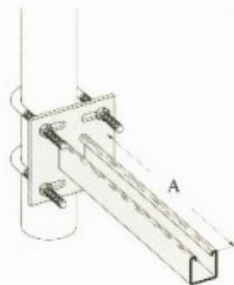

Catalog No.	Uniform Load Lbs.	Uniform Load kN	Tray Width		A	
			in.	mm	in.	mm
HCB-5A	800	3.5	6 & 9	152 & 229	12	305
HCB-5B	450	2.0	12 & 18	305 & 457	21	533

Catalog No.	Uniform Load Lbs.	Uniform Load kN	Tray Width		A	
			in.	mm	in.	mm
HCB- 6A	1660	7.37	6 & 9	152 & 229	12	305
HCB- 6B	1100	4.88	12	305	18	457
HCB- 6C	835	3.71	18	457	24	610
HCB- 6D	665	2.95	24	610	30	762
HCB- 6E	550	2.44	30	762	36	914
HCB- 6F	465	2.06	36	914	42	1067



Vertical Hanger Splice Plates

Outside Cable Tray Ht.	A	
	in.	mm
4"	2.84	72.13
5"	3.73	94.74
6"	4.84	122.93
7"	5.84	148.33



Heavy Duty Hold-Down Bracket

Design load is 2000 lbs/pair.

Two bolt design.

Sold in pairs.

$\frac{3}{8}$ " cable tray attachment hardware provided.

$\frac{1}{2}$ " support attachment hardware **not** provided.

(* Insert ZN or G

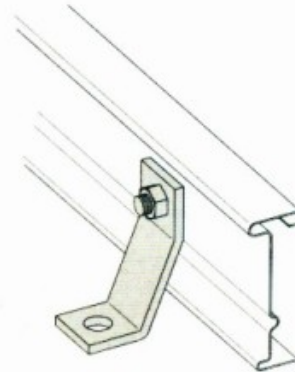

Heavy Duty Hold-Down Bracket

Design load is 4000 lbs/pair.

Four bolt design.

Sold in pairs.

$\frac{3}{8}$ " cable tray attachment hardware provided.

$\frac{1}{2}$ " support attachment hardware **not** provided.

(* Insert ZN or G

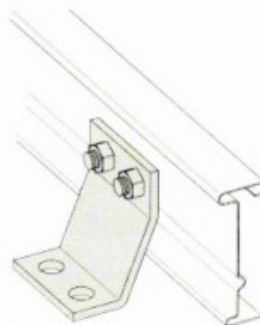

Beam Clamp

Finishes available : ZN
Sold in pieces with hardware.
*When used in pairs.

HBC - 1

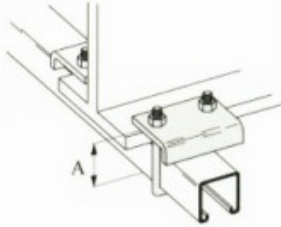

Catalog No.	Design Load Lbs.	Load KN	A	
			in.	mm
HBC-1A	1060	4.71	3 3/8	85.73
HBC-1B	1060	4.71	5	127.00

Beam Clamp

Finishes available : ZN
Sold in pieces.
Design load is 1200 lbs.
When used in pairs
Order HHCS and Channel Nuts separately.

HBC - 2

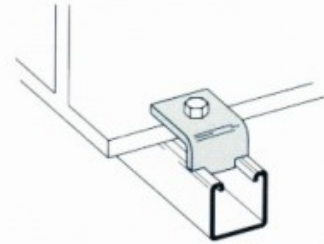

Beam Clamp

Finishes available : ZN
Sold in pieces.
When used in pairs.

HBC - 3

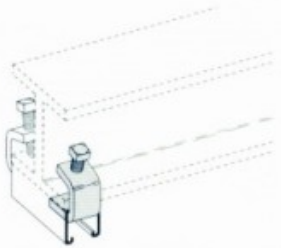

Catalog No.	HBC-3A		HBC-3B	
	Design Load	600 lbs.	2.66 kn	1000 lbs.
Max. Flange Thick	3/4"	19.1 mm	1 1/8"	28.6 mm
Matl. Thickness	1/4"	6.4 mm	3/8"	9.5 mm

Anchor strap

Finishes available : ZN
For a maximum beam thickness 3/4"
For thicker beams, step up one flange width size.

HAS - 1



Catalog No.	Flange Width
HAS- 1A	Up to 6"
HAS- 1B	6" - 9"
HAS- 1C	9" - 12"

Beam Clamp

HBC - 4

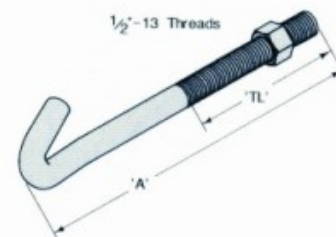

Catalog No.	A		Thread Length *TL*		Wt./C	
	in.	mm	in.	mm	Lbs.	Kg
HBC- 4A	8 1/2"	215.9	5"	127.0	44	19.9
HBC- 4B	11 1/2"	292.1	6"	152.4	53	24.0
HBC- 4C	12 1/4"	311.1	6"	152.4	63	28.6
HBC- 4D	17 1/2"	444.5	6"	152.4	78	35.4

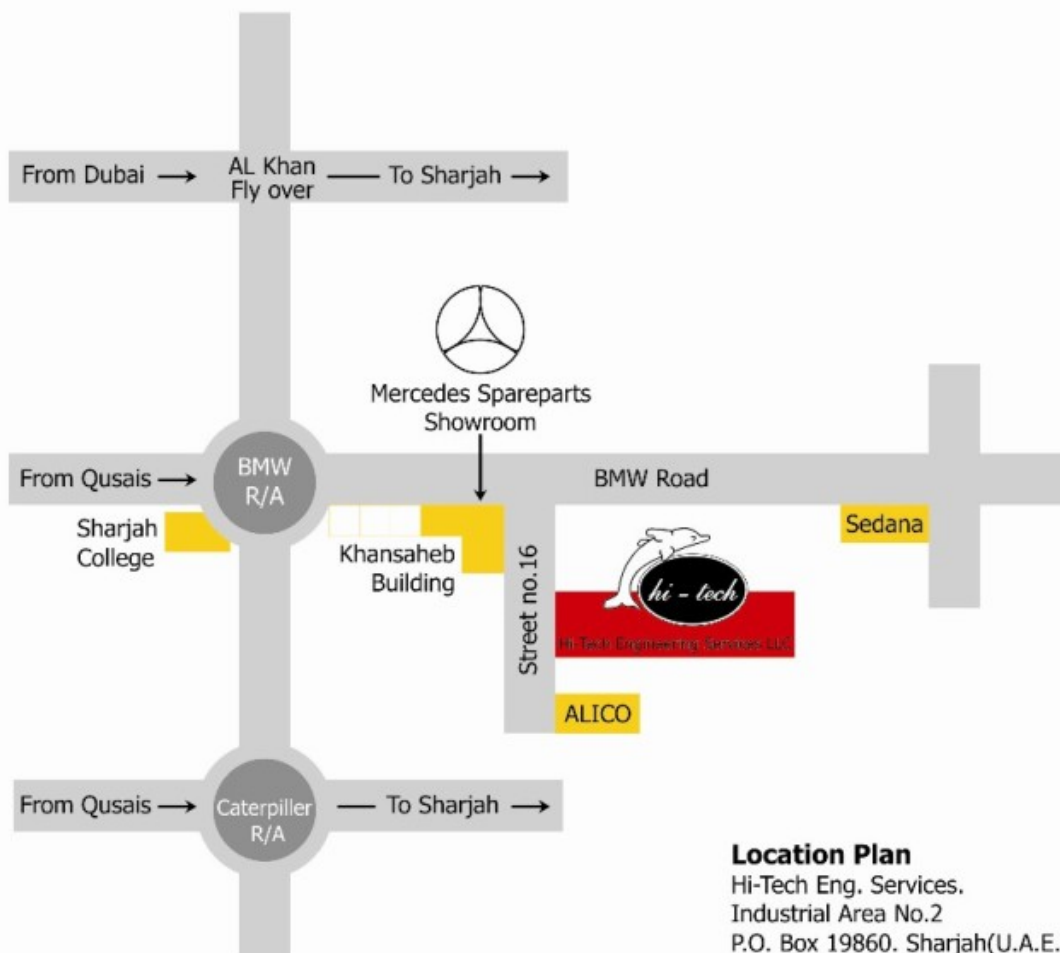

Location Plan
 Hi-Tech Eng. Services.
 Industrial Area No.2
 P.O. Box 19860. Sharjah(U.A.E.)



Hi-Tech Engineering Services LLC

P. O. Box 19860, Sharjah, U.A.E

Tel: 06 - 5332986 • Fax: 06 - 5321319

website: www.hitechuae.com • e-mail: sales@hitechuae.com